

**NOTICE!!**

**These documents have been scanned!**

**Do not place un-scanned documents beneath this notice!**

**Do not remove this notice from this file!**

GPO Jacket No. 560-102  
Print Order 61540  
Rise Business Services, LLC  
Job=AZ15 6/24/2019



Box Number= AZ15126



Claim Begin-End: AMC438984-AMC438999

**1 Initial Receipt**



AZ15126-15

AMC428281-AMC452898



**United States Department of the Interior**  
**Bureau of Land Management**  
 DIV OF LANDS, MINRLS & ENERGY  
 ONE N CENTRAL AVE  
 PHOENIX, AZ 85004 -4427  
 Phone: 602-417-9200

Receipt

No: 3628760

<b>Transaction #:</b> 3732531
<b>Date of Transaction:</b> 08/12/2016
<b>CUSTOMER:</b>
GRAND CANYON GOLD CORP 16772 W BELL RD # 110-417 SURPRISE,AZ 85374-9702 US

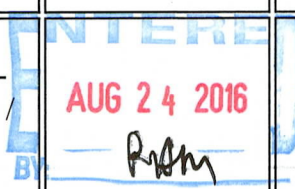
LINE #	QTY	DESCRIPTION	REMARKS	UNIT PRICE	TOTAL
1	16.00	LOCATABLE MINERALS / MINING CLAIMS-NEW,UNADJUD, ONE OR MORE AUTH NOS / NEW MINING CLAIM PROCESSING FEE <b>CASES:</b> AMC438984/\$20.00, AMC438985/\$20.00, AMC438986/\$20.00, AMC438987/\$20.00, AMC438988/\$20.00, AMC438989/\$20.00, AMC438990/\$20.00, AMC438991/\$20.00, AMC438992/\$20.00, AMC438993/\$20.00, AMC438994/\$20.00, AMC438995/\$20.00, AMC438996/\$20.00, AMC438997/\$20.00, AMC438998/\$20.00, AMC438999/\$20.00		- n/a -	320.00
2	16.00	LOCATABLE MINERALS / MINING CLAIMS-NEW,UNADJUD, ONE OR MORE AUTH NOS / NEW MINING CLAIMS LOCATION FEE <b>CASES:</b> AMC438995/\$37.00, AMC438984/\$37.00, AMC438985/\$37.00, AMC438986/\$37.00, AMC438987/\$37.00, AMC438988/\$37.00, AMC438989/\$37.00, AMC438990/\$37.00, AMC438991/\$37.00, AMC438992/\$37.00, AMC438993/\$37.00, AMC438994/\$37.00, AMC438996/\$37.00, AMC438997/\$37.00, AMC438998/\$37.00, AMC438999/\$37.00		- n/a -	592.00
3	16.00	LOCATABLE MINERALS / MINING CLAIMS-NEW,UNADJUD, ONE OR MORE AUTH NOS / NEW MINING CLAIMS MAINTENANCE FEE <b>CASES:</b> AMC438996/\$155.00, AMC438984/\$155.00, AMC438985/\$155.00, AMC438986/\$155.00, AMC438987/\$155.00, AMC438988/\$155.00, AMC438989/\$155.00, AMC438990/\$155.00, AMC438991/\$155.00, AMC438992/		- n/a -	2480.00

		\$155.00, AMC438993/\$155.00, AMC438994/ \$155.00, AMC438995/\$155.00, AMC438997/ \$155.00, AMC438998/\$155.00, AMC438999/ \$155.00			
4	1.00	LOCATABLE MINERALS / MINING CLAIMS- NOT NEW-UNADJUD, ONE AUTH NO. ONLY / MINING CLAIM MONEY RECEIVED <b>CASES:</b> AMC438984/\$2480.00	ADDITIONAL PLACER FEES	- n/a -	2480.00
5	1.00	LOCATABLE MINERALS / MINING CLAIMS- NOT NEW-UNADJUD, ONE AUTH NO. ONLY / MINING CLAIM MONEY RECEIVED <b>CASES:</b> AMC438984/\$4960.00	MAINT 2017/16	- n/a -	4960.00
<b>TOTAL:</b>					<b>\$10,832.00</b>

PAYMENT INFORMATION			
1	AMOUNT:	10832.00	POSTMARKED: N/A
	TYPE:	CHECK	RECEIVED: 08/12/2016
	CHECK NO:	2553	
	NAME:	GRAND CANYON GOLD CORP 16772 W BELL RD # 110-417 SURPRISE AZ 85374-9702 US	

REMARKS

This receipt was generated by the automated BLM Collections and Billing System and is a paper representation of a portion of the official electronic record contained therein.

**NOTICE!!**

**These documents have been scanned!**

**Do not place un-scanned documents beneath this notice!**

**Do not remove this notice from this file!**

GPO Jacket No. 560-102  
Print Order 61540  
Rise Business Services, LLC  
Job=AZ15 6/24/2019



Box Number= AZ15126



Claim Begin-End: AMC438984-AMC438999

**2 Correspondence**



AZ15126-15

AMC428281-AMC452898



# United States Department of the Interior



BUREAU OF LAND MANAGEMENT

Arizona State Office

One North Central Avenue, Suite 800

Phoenix, Arizona 85004-4427

[www.blm.gov/az/](http://www.blm.gov/az/)

NOV 08 2019

In Reply Refer To:

3800 (9200) PB

AMC438488; AMC438984;

CERTIFIED MAIL - RETURN RECEIPT REQUESTED No. 9214 8901 9403 8398 3360 66

## DECISION

GIANNEOTIS DENISE E and	:	This decision affects those claims
GRAND CANYON GOLD CORP	:	shown on the attached list(s).
16772 W BELL RD # 110-417	:	
SURPRISE, AZ 85374-9702	:	

---

SEE ATTACHMENT(S) FOR CLAIM NAMES AND AMC NUMBERS

---

## MINING CLAIMS DECLARED FORFEITED

The mining claims listed above have been declared forfeited as of September 1, 2019, for failure to timely file the required maintenance fee payment or small miner's maintenance fee waiver (waiver).

Claimants are required to pay an annual non-refundable maintenance fee of \$165 per 20 acres or portion thereof, or submit a waiver, on or before September 1 of each year. These requirements were established by 30 U.S.C. 28f-1, as amended, and 43 CFR 3834 and 3835.

Our records do not show receipt of a maintenance fee payment or small miner waiver filed on or before the due date. Therefore, the claims listed above are forfeited.

## Reclamation Requirements

This decision does not relieve you of the liability for reclamation of all areas disturbed by your activities on lands covered by the subject mining claim(s) and/or site(s). After you complete the reclamation, you must notify the authorized officer of the appropriate surface managing agency so that the authorized officer may conduct a final site inspection and determine whether you may be released from liability. If you fail to reclaim the land to the satisfaction of the authorized officer, the surface management agency may cite you for noncompliance under its surface management regulations. For land administered by the Bureau of Land Management (BLM), if

you fail to reclaim the land to the satisfaction of the authorized officer as required in 43 CFR Subpart 3809, the BLM will issue an order of noncompliance under 43CFR 3809.601(a). If you fail to comply with the non-compliance order, BLM may take further action under 43 CFR 3809.604. Failure to conduct reclamation is a prohibited act that may subject you to criminal penalties. See 43 CFR 3809.605(h) and 43 CFR 3809.700.

### Appeal Procedures

This decision may be appealed to the Interior Board of Land Appeals, Office of the Secretary, in accordance with the regulations contained in 43 CFR, Part 4, and the enclosed Form 1842-1. If an appeal is taken, your notice of appeal must be filed in this office (at the above address) within 30 days from receipt of this decision. The appellant has the burden of showing that the decision appealed from is in error.

If you wish to file a petition pursuant to regulation 43 CFR 4.21 (58 FR 4939, January 19, 1993) for a stay of the effectiveness of this decision during the time that your appeal is being reviewed by the Board, the petition for a stay must accompany your notice of appeal. A petition for a stay is required to show sufficient justification based on the standards listed below. Copies of the notice of appeal and petition for a stay **must** also be submitted to each party named in this decision and to the Interior Board of Land Appeals and to the appropriate Office of the Solicitor (see 43 CFR 4.413) at the same time the original documents are filed with this office. If you request a stay, you have the burden of proof to demonstrate that a stay should be granted.

### Standards for Obtaining a Stay

Except as otherwise provided by law or other pertinent regulation, a petition for a stay of a decision pending appeal shall show sufficient justification based on the following standards:

- (1) The relative harm to the parties if the stay is granted or denied,
- (1) The likelihood of the appellant's success on the merits,
- (2) The likelihood of immediate and irreparable harm if the stay is not granted, and
- (3) Whether the public interest favors granting the stay.

Please include your AMC serial number(s) on all correspondence. If additional information is required, please call Pauline Brown at 602-417-9360.



Elena Fink  
Deputy State Director  
Lands, Minerals and Energy Division

Enclosure(s)

US Department of the Interior  
Bureau of Land Management  
1 N Central Ave Ste 800  
Phoenix, AZ 85004

---

USPS CERTIFIED MAIL



9214 8901 9403 8398 3360 66

---

GIANNEOTIS DENISE E AND  
GRAND CANYON GOLD CORP  
16772 W BELL RD UNIT 110-417  
SURPRISE AZ 85374-9702



DENISE E GIANNEOTIS  
 16772 W BELL RD # 110-417  
 SURPRISE, AZ 85374-9702

Serial Number	Lead Serial	Claim Name	Last Assmt Year
AMC438488	AMC438488	P17	2019
AMC438489	AMC438488	P17-1	2019
AMC438490	AMC438488	P17-2	2019
AMC438491	AMC438488	P17-3	2019
AMC438492	AMC438488	P17-4	2019
AMC438493	AMC438488	P17-5	2019
AMC438494	AMC438488	P17-6	2019
AMC438495	AMC438488	P17-7	2019
AMC438496	AMC438488	P17-8	2019
AMC438497	AMC438488	P17-9	2019
AMC438498	AMC438488	P17-10	2019
AMC438499	AMC438488	P17-11	2019
AMC438500	AMC438488	P17-12	2019
AMC438501	AMC438488	P17-13	2019
AMC438502	AMC438488	P17-14	2019
AMC438503	AMC438488	P17-15	2019
AMC438984	AMC438984	P7	2019
AMC438985	AMC438984	P7-1	2019
AMC438986	AMC438984	P7-2	2019
AMC438987	AMC438984	P7-3	2019
AMC438988	AMC438984	P7-4	2019
AMC438989	AMC438984	P7-5	2019
AMC438990	AMC438984	P7-6	2019
AMC438991	AMC438984	P7-7	2019
AMC438992	AMC438984	P7-8	2019
AMC438993	AMC438984	P7-9	2019
AMC438994	AMC438984	P7-10	2019
AMC438995	AMC438984	P7-11	2019
AMC438996	AMC438984	P7-12	2019
AMC438997	AMC438984	P7-13	2019
AMC438998	AMC438984	P7-14	2019
AMC438999	AMC438984	P7-15	2019



Date Produced: 11/18/2019

ConnectSuite Inc.:

The following is the delivery information for Certified Mail™/RRE item number 9214 8901 9403 8398 3360 66. Our records indicate that this item was delivered on 11/15/2019 at 11:11 a.m. in SURPRISE, AZ 85374. The scanned image of the recipient information is provided below.

Signature of Recipient :

*RS Hall*  
ROBERT HALL

Address of Recipient :

**16772 W BELL RD  
SURPRISE, AZ 85374**

Thank you for selecting the Postal Service for your mailing needs. If you require additional assistance, please contact your local post office or Postal Service representative.

Sincerely,  
United States Postal Service

The customer reference number shown below is not validated or endorsed by the United States Postal Service. It is solely for customer use.

Customer Reference Number: C1744151.9937754



# United States Department of the Interior



BUREAU OF LAND MANAGEMENT

Arizona State Office

One North Central Avenue, Suite 800

Phoenix, Arizona 85004-4427

[www.blm.gov/az/](http://www.blm.gov/az/)

NOV 08 2019

In Reply Refer To:

3800 (9200) PB

AMC438198; AMC438292; AMC438422; AMC438488; AMC438849; AMC438984;

AMC445505;

CERTIFIED MAIL - RETURN RECEIPT REQUESTED No. 9214 8901 9403 8398 3361 27

## DECISION

GRAND CANYON GOLD CORP	:	This decision affects those claims
16772 W BELL RD # 110-417	:	shown on the attached list(s).
SURPRISE, AZ 85374-9702	:	

---

SEE ATTACHMENT(S) FOR CLAIM NAMES AND AMC NUMBERS

---

### MINING CLAIMS DECLARED FORFEITED

The mining claims listed above have been declared forfeited as of September 1, 2019, for failure to timely file the required maintenance fee payment or small miner's maintenance fee waiver (waiver).

Claimants are required to pay an annual non-refundable maintenance fee of \$165 per 20 acres or portion thereof, or submit a waiver, on or before September 1 of each year. These requirements were established by 30 U.S.C. 28f-l, as amended, and 43 CFR 3834 and 3835.

Our records do not show receipt of a maintenance fee payment or small miner waiver filed on or before the due date. Therefore, the claims listed above are forfeited.

### Reclamation Requirements

This decision does not relieve you of the liability for reclamation of all areas disturbed by your activities on lands covered by the subject mining claim(s) and/or site(s). After you complete the reclamation, you must notify the authorized officer of the appropriate surface managing agency so that the authorized officer may conduct a final site inspection and determine whether you may be released from liability. If you fail to reclaim the land to the satisfaction of the authorized officer, the surface management agency may cite you for noncompliance under its surface management regulations. For land administered by the Bureau of Land Management (BLM), if

you fail to reclaim the land to the satisfaction of the authorized officer as required in 43 CFR Subpart 3809, the BLM will issue an order of noncompliance under 43CFR 3809.601(a). If you fail to comply with the non-compliance order, BLM may take further action under 43 CFR 3809.604. Failure to conduct reclamation is a prohibited act that may subject you to criminal penalties. See 43 CFR 3809.605(h) and 43 CFR 3809.700.

### Appeal Procedures

This decision may be appealed to the Interior Board of Land Appeals, Office of the Secretary, in accordance with the regulations contained in 43 CFR, Part 4, and the enclosed Form 1842-1. If an appeal is taken, your notice of appeal must be filed in this office (at the above address) within 30 days from receipt of this decision. The appellant has the burden of showing that the decision appealed from is in error.

If you wish to file a petition pursuant to regulation 43 CFR 4.21 (58 FR 4939, January 19, 1993) for a stay of the effectiveness of this decision during the time that your appeal is being reviewed by the Board, the petition for a stay must accompany your notice of appeal. A petition for a stay is required to show sufficient justification based on the standards listed below. Copies of the notice of appeal and petition for a stay **must** also be submitted to each party named in this decision and to the Interior Board of Land Appeals and to the appropriate Office of the Solicitor (see 43 CFR 4.413) at the same time the original documents are filed with this office. If you request a stay, you have the burden of proof to demonstrate that a stay should be granted.

### Standards for Obtaining a Stay

Except as otherwise provided by law or other pertinent regulation, a petition for a stay of a decision pending appeal shall show sufficient justification based on the following standards:

- (1) The relative harm to the parties if the stay is granted or denied,
- (1) The likelihood of the appellant's success on the merits,
- (2) The likelihood of immediate and irreparable harm if the stay is not granted, and
- (3) Whether the public interest favors granting the stay.

Please include your AMC serial number(s) on all correspondence. If additional information is required, please call Pauline Brown at 602-417-9360.



Elena Fink  
Deputy State Director  
Lands, Minerals and Energy Division

Enclosure(s)

US Department of the Interior  
Bureau of Land Management  
1 N Central Ave Ste 800  
Phoenix, AZ 85004

---

USPS CERTIFIED MAIL



9214 8901 9403 8398 3361 27

---

GRAND CANYON GOLD CORP  
16772 W BELL RD UNIT 110-417  
SURPRISE AZ 85374-9702

**MINING CLAIM LISTING FOR: GRAND CANYON GOLD CORP**  
**16772 W BELL RD # 110-417**  
**SURPRISE AZ 85374-9702**

Serial Number	Lead Serial Number	Claim Name	Last Assmt Year
AMC438198	AMC438198	22-A	2019
AMC438199	AMC438198	22-A2	2019
AMC438200	AMC438198	22-A3	2019
AMC438201	AMC438198	22-A4	2019
AMC438202	AMC438198	22-B	2019
AMC438203	AMC438198	22-B2	2019
AMC438204	AMC438198	22-B3	2019
AMC438205	AMC438198	22-B4	2019
AMC438206	AMC438198	22-C	2019
AMC438207	AMC438198	22-C2	2019
AMC438208	AMC438198	22-C3	2019
AMC438209	AMC438198	22-C4	2019
AMC438210	AMC438198	22-D	2019
AMC438211	AMC438198	22-D2	2019
AMC438212	AMC438198	22-D3	2019
AMC438213	AMC438198	22-D4	2019
AMC438292	AMC438292	20-A	2019
AMC438293	AMC438292	20-A2	2019
AMC438294	AMC438292	20-A3	2019
AMC438295	AMC438292	20-A4	2019
AMC438296	AMC438292	20-B	2019
AMC438297	AMC438292	20-B2	2019
AMC438298	AMC438292	20-B3	2019
AMC438299	AMC438292	20-B4	2019
AMC438300	AMC438292	20-C	2019
AMC438301	AMC438292	20-C2	2019
AMC438302	AMC438292	20-C3	2019
AMC438303	AMC438292	20-C4	2019
AMC438304	AMC438292	20-D	2019
AMC438305	AMC438292	20-D2	2019
AMC438306	AMC438292	20-D3	2019
AMC438307	AMC438292	20-D4	2019
AMC438308	AMC438292	21-A	2019
AMC438309	AMC438292	21-A2	2019
AMC438310	AMC438292	21-A3	2019
AMC438311	AMC438292	21-A4	2019
AMC438312	AMC438292	21-B	2019
AMC438313	AMC438292	21-B2	2019
AMC438314	AMC438292	21-B3	2019
AMC438315	AMC438292	21-B4	2019
AMC438316	AMC438292	21-C	2019
AMC438317	AMC438292	21-C2	2019
AMC438318	AMC438292	21-C3	2019
AMC438319	AMC438292	21-C4	2019
AMC438320	AMC438292	21-D	2019
AMC438321	AMC438292	21-D2	2019

Serial Number	Lead Serial Number	Claim Name	Last Assmt Year
AMC438322	AMC438292	21-D3	2019
AMC438323	AMC438292	21-D4	2019
AMC438422	AMC438422	19-A	2019
AMC438423	AMC438422	19-A2	2019
AMC438424	AMC438422	19-A3	2019
AMC438425	AMC438422	19-A4	2019
AMC438426	AMC438422	19-B	2019
AMC438427	AMC438422	19-B2	2019
AMC438428	AMC438422	19-B3	2019
AMC438429	AMC438422	19-B4	2019
AMC438430	AMC438422	19-C	2019
AMC438431	AMC438422	19-C2	2019
AMC438432	AMC438422	19-C3	2019
AMC438433	AMC438422	19-C4	2019
AMC438434	AMC438422	19-D	2019
AMC438435	AMC438422	19-D2	2019
AMC438436	AMC438422	19-D3	2019
AMC438437	AMC438422	19-D4	2019
AMC438438	AMC438422	30-A	2019
AMC438439	AMC438422	30-A2	2019
AMC438440	AMC438422	30-A3	2019
AMC438441	AMC438422	30-A4	2019
AMC438442	AMC438422	30-B	2019
AMC438443	AMC438422	30-B2	2019
AMC438444	AMC438422	30-B3	2019
AMC438445	AMC438422	30-B4	2019
AMC438446	AMC438422	30-C	2019
AMC438447	AMC438422	30-C2	2019
AMC438448	AMC438422	30-C3	2019
AMC438449	AMC438422	30-C4	2019
AMC438450	AMC438422	30-D	2019
AMC438451	AMC438422	30-D2	2019
AMC438452	AMC438422	30-D3	2019
AMC438453	AMC438422	30-D4	2019
AMC438488	AMC438488	P17	2019
AMC438489	AMC438488	P17-1	2019
AMC438490	AMC438488	P17-2	2019
AMC438491	AMC438488	P17-3	2019
AMC438492	AMC438488	P17-4	2019
AMC438493	AMC438488	P17-5	2019
AMC438494	AMC438488	P17-6	2019
AMC438495	AMC438488	P17-7	2019
AMC438496	AMC438488	P17-8	2019
AMC438497	AMC438488	P17-9	2019
AMC438498	AMC438488	P17-10	2019
AMC438499	AMC438488	P17-11	2019

Serial Number	Lead Serial Number	Claim Name	Last Assmt Year
AMC438500	AMC438488	P17-12	2019
AMC438501	AMC438488	P17-13	2019
AMC438502	AMC438488	P17-14	2019
AMC438503	AMC438488	P17-15	2019
AMC438849	AMC438849	35-A	2019
AMC438850	AMC438849	35-A2	2019
AMC438851	AMC438849	35-A3	2019
AMC438852	AMC438849	35-A4	2019
AMC438853	AMC438849	35-B	2019
AMC438854	AMC438849	35-B2	2019
AMC438855	AMC438849	35-B3	2019
AMC438856	AMC438849	35-B4	2019
AMC438857	AMC438849	35-C	2019
AMC438858	AMC438849	35-C2	2019
AMC438859	AMC438849	35-C3	2019
AMC438860	AMC438849	35-C4	2019
AMC438861	AMC438849	35-D	2019
AMC438862	AMC438849	35-D2	2019
AMC438863	AMC438849	35-D3	2019
AMC438864	AMC438849	35-D4	2019
AMC438984	AMC438984	P7	2019
AMC438985	AMC438984	P7-1	2019
AMC438986	AMC438984	P7-2	2019
AMC438987	AMC438984	P7-3	2019
AMC438988	AMC438984	P7-4	2019
AMC438989	AMC438984	P7-5	2019
AMC438990	AMC438984	P7-6	2019
AMC438991	AMC438984	P7-7	2019
AMC438992	AMC438984	P7-8	2019
AMC438993	AMC438984	P7-9	2019
AMC438994	AMC438984	P7-10	2019
AMC438995	AMC438984	P7-11	2019
AMC438996	AMC438984	P7-12	2019
AMC438997	AMC438984	P7-13	2019
AMC438998	AMC438984	P7-14	2019

Serial Number	Lead Serial Number	Claim Name	Last Assmt Year
AMC438999	AMC438984	P7-15	2019
AMC445505	AMC445505	IDCF 1	2019
AMC445506	AMC445505	IDCF 2	2019
AMC445507	AMC445505	IDCF 3	2019
AMC445508	AMC445505	IDCF 4	2019
AMC445509	AMC445505	IDCF 5	2019
AMC445510	AMC445505	IDCF 6	2019
AMC445511	AMC445505	IDCF 7	2019
AMC445512	AMC445505	IDCF 8	2019
AMC445513	AMC445505	IDCF 9	2019
AMC445514	AMC445505	IDCF 10	2019
AMC445515	AMC445505	IDCF 11	2019
AMC445516	AMC445505	IDCF 12	2019
AMC445517	AMC445505	IDCF 13	2019
AMC445518	AMC445505	IDCF 14	2019
AMC445519	AMC445505	IDCF 15	2019
AMC445520	AMC445505	IDCF 16	2019
AMC445521	AMC445505	IDCF 17	2019
AMC445522	AMC445505	IDCF 18	2019
AMC445523	AMC445505	IDCF 19	2019
AMC445524	AMC445505	IDCF 20	2019
AMC445525	AMC445505	IDCF 21	2019
AMC445526	AMC445505	IDCF 22	2019
AMC445527	AMC445505	IDCF 23	2019
AMC445528	AMC445505	IDCF 24	2019
AMC445529	AMC445505	IDCF 25	2019
AMC445530	AMC445505	IDCF 26	2019
AMC445531	AMC445505	IDCF 27	2019
AMC445532	AMC445505	IDCF 28	2019
AMC445533	AMC445505	IDCF 29	2019
AMC445534	AMC445505	IDCF 30	2019
AMC445535	AMC445505	IDCF 31	2019
AMC445536	AMC445505	IDCF 32	2019



Date Produced: 11/18/2019

ConnectSuite Inc.:

The following is the delivery information for Certified Mail™/RRE item number 9214 8901 9403 8398 3361 27. Our records indicate that this item was delivered on 11/15/2019 at 11:11 a.m. in SURPRISE, AZ 85374. The scanned image of the recipient information is provided below.

Signature of Recipient :

*RS Hall*  
ROBERT HALL

Address of Recipient :

**16772 W BELL RD  
SURPRISE, AZ 85374**

Thank you for selecting the Postal Service for your mailing needs. If you require additional assistance, please contact your local post office or Postal Service representative.

Sincerely,  
United States Postal Service

The customer reference number shown below is not validated or endorsed by the United States Postal Service. It is solely for customer use.

Customer Reference Number: C1744151.9937755





# United States Department of the Interior



BUREAU OF LAND MANAGEMENT

Arizona State Office

One North Central Avenue, Suite 800

Phoenix, Arizona 85004-4427

[www.blm.gov/az/](http://www.blm.gov/az/)

NOV 08 2019

In Reply Refer To:

3800 (9200) PB

AMC438198; AMC438292; AMC438422; AMC438488; AMC438849; AMC438984;

AMC445505;

CERTIFIED MAIL - RETURN RECEIPT REQUESTED No. 9214 8901 9403 8398 3361 27

## DECISION

GRAND CANYON GOLD CORP	:	This decision affects those claims
16772 W BELL RD # 110-417	:	shown on the attached list(s).
SURPRISE, AZ 85374-9702	:	

---

SEE ATTACHMENT(S) FOR CLAIM NAMES AND AMC NUMBERS

---

### MINING CLAIMS DECLARED FORFEITED

The mining claims listed above have been declared forfeited as of September 1, 2019, for failure to timely file the required maintenance fee payment or small miner's maintenance fee waiver (waiver).

Claimants are required to pay an annual non-refundable maintenance fee of \$165 per 20 acres or portion thereof, or submit a waiver, on or before September 1 of each year. These requirements were established by 30 U.S.C. 28f-l, as amended, and 43 CFR 3834 and 3835.

Our records do not show receipt of a maintenance fee payment or small miner waiver filed on or before the due date. Therefore, the claims listed above are forfeited.

### Reclamation Requirements

This decision does not relieve you of the liability for reclamation of all areas disturbed by your activities on lands covered by the subject mining claim(s) and/or site(s). After you complete the reclamation, you must notify the authorized officer of the appropriate surface managing agency so that the authorized officer may conduct a final site inspection and determine whether you may be released from liability. If you fail to reclaim the land to the satisfaction of the authorized officer, the surface management agency may cite you for noncompliance under its surface management regulations. For land administered by the Bureau of Land Management (BLM), if

you fail to reclaim the land to the satisfaction of the authorized officer as required in 43 CFR Subpart 3809, the BLM will issue an order of noncompliance under 43CFR 3809.601(a). If you fail to comply with the non-compliance order, BLM may take further action under 43 CFR 3809.604. Failure to conduct reclamation is a prohibited act that may subject you to criminal penalties. See 43 CFR 3809.605(h) and 43 CFR 3809.700.

### Appeal Procedures

This decision may be appealed to the Interior Board of Land Appeals, Office of the Secretary, in accordance with the regulations contained in 43 CFR, Part 4, and the enclosed Form 1842-1. If an appeal is taken, your notice of appeal must be filed in this office (at the above address) within 30 days from receipt of this decision. The appellant has the burden of showing that the decision appealed from is in error.

If you wish to file a petition pursuant to regulation 43 CFR 4.21 (58 FR 4939, January 19, 1993) for a stay of the effectiveness of this decision during the time that your appeal is being reviewed by the Board, the petition for a stay must accompany your notice of appeal. A petition for a stay is required to show sufficient justification based on the standards listed below. Copies of the notice of appeal and petition for a stay **must** also be submitted to each party named in this decision and to the Interior Board of Land Appeals and to the appropriate Office of the Solicitor (see 43 CFR 4.413) at the same time the original documents are filed with this office. If you request a stay, you have the burden of proof to demonstrate that a stay should be granted.

### Standards for Obtaining a Stay

Except as otherwise provided by law or other pertinent regulation, a petition for a stay of a decision pending appeal shall show sufficient justification based on the following standards:

- (1) The relative harm to the parties if the stay is granted or denied,
- (1) The likelihood of the appellant's success on the merits,
- (2) The likelihood of immediate and irreparable harm if the stay is not granted, and
- (3) Whether the public interest favors granting the stay.

Please include your AMC serial number(s) on all correspondence. If additional information is required, please call Pauline Brown at 602-417-9360.



Elena Fink  
Deputy State Director  
Lands, Minerals and Energy Division

Enclosure(s)

US Department of the Interior  
Bureau of Land Management  
1 N Central Ave Ste 800  
Phoenix, AZ 85004

---

USPS CERTIFIED MAIL



9214 8901 9403 8398 3361 27

---

GRAND CANYON GOLD CORP  
16772 W BELL RD UNIT 110-417  
SURPRISE AZ 85374-9702

**MINING CLAIM LISTING FOR: GRAND CANYON GOLD CORP**  
**16772 W BELL RD # 110-417**  
**SURPRISE AZ 85374-9702**

Serial Number	Lead Serial Number	Claim Name	Last Assmt Year
AMC438198	AMC438198	22-A	2019
AMC438199	AMC438198	22-A2	2019
AMC438200	AMC438198	22-A3	2019
AMC438201	AMC438198	22-A4	2019
AMC438202	AMC438198	22-B	2019
AMC438203	AMC438198	22-B2	2019
AMC438204	AMC438198	22-B3	2019
AMC438205	AMC438198	22-B4	2019
AMC438206	AMC438198	22-C	2019
AMC438207	AMC438198	22-C2	2019
AMC438208	AMC438198	22-C3	2019
AMC438209	AMC438198	22-C4	2019
AMC438210	AMC438198	22-D	2019
AMC438211	AMC438198	22-D2	2019
AMC438212	AMC438198	22-D3	2019
AMC438213	AMC438198	22-D4	2019
AMC438292	AMC438292	20-A	2019
AMC438293	AMC438292	20-A2	2019
AMC438294	AMC438292	20-A3	2019
AMC438295	AMC438292	20-A4	2019
AMC438296	AMC438292	20-B	2019
AMC438297	AMC438292	20-B2	2019
AMC438298	AMC438292	20-B3	2019
AMC438299	AMC438292	20-B4	2019
AMC438300	AMC438292	20-C	2019
AMC438301	AMC438292	20-C2	2019
AMC438302	AMC438292	20-C3	2019
AMC438303	AMC438292	20-C4	2019
AMC438304	AMC438292	20-D	2019
AMC438305	AMC438292	20-D2	2019
AMC438306	AMC438292	20-D3	2019
AMC438307	AMC438292	20-D4	2019
AMC438308	AMC438292	21-A	2019
AMC438309	AMC438292	21-A2	2019
AMC438310	AMC438292	21-A3	2019
AMC438311	AMC438292	21-A4	2019
AMC438312	AMC438292	21-B	2019
AMC438313	AMC438292	21-B2	2019
AMC438314	AMC438292	21-B3	2019
AMC438315	AMC438292	21-B4	2019
AMC438316	AMC438292	21-C	2019
AMC438317	AMC438292	21-C2	2019
AMC438318	AMC438292	21-C3	2019
AMC438319	AMC438292	21-C4	2019
AMC438320	AMC438292	21-D	2019
AMC438321	AMC438292	21-D2	2019

Serial Number	Lead Serial Number	Claim Name	Last Assmt Year
AMC438322	AMC438292	21-D3	2019
AMC438323	AMC438292	21-D4	2019
AMC438422	AMC438422	19-A	2019
AMC438423	AMC438422	19-A2	2019
AMC438424	AMC438422	19-A3	2019
AMC438425	AMC438422	19-A4	2019
AMC438426	AMC438422	19-B	2019
AMC438427	AMC438422	19-B2	2019
AMC438428	AMC438422	19-B3	2019
AMC438429	AMC438422	19-B4	2019
AMC438430	AMC438422	19-C	2019
AMC438431	AMC438422	19-C2	2019
AMC438432	AMC438422	19-C3	2019
AMC438433	AMC438422	19-C4	2019
AMC438434	AMC438422	19-D	2019
AMC438435	AMC438422	19-D2	2019
AMC438436	AMC438422	19-D3	2019
AMC438437	AMC438422	19-D4	2019
AMC438438	AMC438422	30-A	2019
AMC438439	AMC438422	30-A2	2019
AMC438440	AMC438422	30-A3	2019
AMC438441	AMC438422	30-A4	2019
AMC438442	AMC438422	30-B	2019
AMC438443	AMC438422	30-B2	2019
AMC438444	AMC438422	30-B3	2019
AMC438445	AMC438422	30-B4	2019
AMC438446	AMC438422	30-C	2019
AMC438447	AMC438422	30-C2	2019
AMC438448	AMC438422	30-C3	2019
AMC438449	AMC438422	30-C4	2019
AMC438450	AMC438422	30-D	2019
AMC438451	AMC438422	30-D2	2019
AMC438452	AMC438422	30-D3	2019
AMC438453	AMC438422	30-D4	2019
AMC438488	AMC438488	P17	2019
AMC438489	AMC438488	P17-1	2019
AMC438490	AMC438488	P17-2	2019
AMC438491	AMC438488	P17-3	2019
AMC438492	AMC438488	P17-4	2019
AMC438493	AMC438488	P17-5	2019
AMC438494	AMC438488	P17-6	2019
AMC438495	AMC438488	P17-7	2019
AMC438496	AMC438488	P17-8	2019
AMC438497	AMC438488	P17-9	2019
AMC438498	AMC438488	P17-10	2019
AMC438499	AMC438488	P17-11	2019

Serial Number	Lead Serial Number	Claim Name	Last Assmt Year
AMC438500	AMC438488	P17-12	2019
AMC438501	AMC438488	P17-13	2019
AMC438502	AMC438488	P17-14	2019
AMC438503	AMC438488	P17-15	2019
AMC438849	AMC438849	35-A	2019
AMC438850	AMC438849	35-A2	2019
AMC438851	AMC438849	35-A3	2019
AMC438852	AMC438849	35-A4	2019
AMC438853	AMC438849	35-B	2019
AMC438854	AMC438849	35-B2	2019
AMC438855	AMC438849	35-B3	2019
AMC438856	AMC438849	35-B4	2019
AMC438857	AMC438849	35-C	2019
AMC438858	AMC438849	35-C2	2019
AMC438859	AMC438849	35-C3	2019
AMC438860	AMC438849	35-C4	2019
AMC438861	AMC438849	35-D	2019
AMC438862	AMC438849	35-D2	2019
AMC438863	AMC438849	35-D3	2019
AMC438864	AMC438849	35-D4	2019
AMC438984	AMC438984	P7	2019
AMC438985	AMC438984	P7-1	2019
AMC438986	AMC438984	P7-2	2019
AMC438987	AMC438984	P7-3	2019
AMC438988	AMC438984	P7-4	2019
AMC438989	AMC438984	P7-5	2019
AMC438990	AMC438984	P7-6	2019
AMC438991	AMC438984	P7-7	2019
AMC438992	AMC438984	P7-8	2019
AMC438993	AMC438984	P7-9	2019
AMC438994	AMC438984	P7-10	2019
AMC438995	AMC438984	P7-11	2019
AMC438996	AMC438984	P7-12	2019
AMC438997	AMC438984	P7-13	2019
AMC438998	AMC438984	P7-14	2019

Serial Number	Lead Serial Number	Claim Name	Last Assmt Year
AMC438999	AMC438984	P7-15	2019
AMC445505	AMC445505	IDCF 1	2019
AMC445506	AMC445505	IDCF 2	2019
AMC445507	AMC445505	IDCF 3	2019
AMC445508	AMC445505	IDCF 4	2019
AMC445509	AMC445505	IDCF 5	2019
AMC445510	AMC445505	IDCF 6	2019
AMC445511	AMC445505	IDCF 7	2019
AMC445512	AMC445505	IDCF 8	2019
AMC445513	AMC445505	IDCF 9	2019
AMC445514	AMC445505	IDCF 10	2019
AMC445515	AMC445505	IDCF 11	2019
AMC445516	AMC445505	IDCF 12	2019
AMC445517	AMC445505	IDCF 13	2019
AMC445518	AMC445505	IDCF 14	2019
AMC445519	AMC445505	IDCF 15	2019
AMC445520	AMC445505	IDCF 16	2019
AMC445521	AMC445505	IDCF 17	2019
AMC445522	AMC445505	IDCF 18	2019
AMC445523	AMC445505	IDCF 19	2019
AMC445524	AMC445505	IDCF 20	2019
AMC445525	AMC445505	IDCF 21	2019
AMC445526	AMC445505	IDCF 22	2019
AMC445527	AMC445505	IDCF 23	2019
AMC445528	AMC445505	IDCF 24	2019
AMC445529	AMC445505	IDCF 25	2019
AMC445530	AMC445505	IDCF 26	2019
AMC445531	AMC445505	IDCF 27	2019
AMC445532	AMC445505	IDCF 28	2019
AMC445533	AMC445505	IDCF 29	2019
AMC445534	AMC445505	IDCF 30	2019
AMC445535	AMC445505	IDCF 31	2019
AMC445536	AMC445505	IDCF 32	2019



Date Produced: 11/18/2019

ConnectSuite Inc.:

The following is the delivery information for Certified Mail™/RRE item number 9214 8901 9403 8398 3361 27. Our records indicate that this item was delivered on 11/15/2019 at 11:11 a.m. in SURPRISE, AZ 85374. The scanned image of the recipient information is provided below.

Signature of Recipient :

*RS Hall*  
ROBERT HALL

Address of Recipient :

**16772 W BELL RD  
SURPRISE, AZ 85374**

Thank you for selecting the Postal Service for your mailing needs. If you require additional assistance, please contact your local post office or Postal Service representative.

Sincerely,  
United States Postal Service

The customer reference number shown below is not validated or endorsed by the United States Postal Service. It is solely for customer use.

Customer Reference Number: C1744151.9937755

**NO  
DOCUMENTS  
FOUND**

NO DOCUMENTS FOUND  
NO DOCUMENTS FOUND

**NOTICE!!**

**These documents have been scanned!**

**Do not place un-scanned documents beneath this notice!**

**Do not remove this notice from this file!**

GPO Jacket No. 560-102  
Print Order 61540  
Rise Business Services, LLC  
Job=AZ15 6/24/2019



Box Number= AZ15126



Claim Begin-End: AMC438984-AMC438999

**3 Transfers**



AZ15126-15

AMC428281-AMC452898



**NO  
DOCUMENTS  
FOUND**

NO DOCUMENTS FOUND  
NO DOCUMENTS FOUND

**NOTICE!!**

**These documents have been scanned!**

**Do not place un-scanned documents beneath this notice!**

**Do not remove this notice from this file!**

GPO Jacket No. 560-102  
Print Order 61540  
Rise Business Services, LLC  
Job=AZ15 6/24/2019



Box Number= AZ15126



Claim Begin-End: AMC438984-AMC438999

**4 Annual Filings**



AZ15126-15

AMC428281-AMC452898

DEPARTMENT OF THE INTERIOR  
BUREAU OF LAND MANAGEMENT  
MINING CLAIMS

Run Date/Time: 9/11/2018

MC Maintenance Fees Paid Through the BLM Pay Portal  
(by Date Paid)

Page 716 Of 723

**CBS Receipt: 4255899**

Printed For Lead File # AMC438984

Agency Tracking ID: 1536085851

Assessment Year: 2019

Paid On: 9/4/2018

Number of BLM Serial Nr: 16

Total Amount Paid: \$4,960.00

Claim Name	BLM Serial No	Lead File No	Amount Paid
P7	AMC438984	AMC438984	\$310.00
P7-1	AMC438985	AMC438984	\$310.00
P7-2	AMC438986	AMC438984	\$310.00
P7-3	AMC438987	AMC438984	\$310.00
P7-4	AMC438988	AMC438984	\$310.00
P7-5	AMC438989	AMC438984	\$310.00
P7-6	AMC438990	AMC438984	\$310.00
P7-7	AMC438991	AMC438984	\$310.00
P7-8	AMC438992	AMC438984	\$310.00
P7-9	AMC438993	AMC438984	\$310.00
P7-10	AMC438994	AMC438984	\$310.00
P7-11	AMC438995	AMC438984	\$310.00
P7-12	AMC438996	AMC438984	\$310.00
P7-13	AMC438997	AMC438984	\$310.00
P7-14	AMC438998	AMC438984	\$310.00
P7-15	AMC438999	AMC438984	\$310.00

**United States Department of the Interior**  
**Bureau of Land Management**  
 BUSINESS & SUPPORT SVCS DIV  
 ONE N CENTRAL AVE SUITE 800  
 PHOENIX, AZ 85004 -4427  
 Phone: 602-417-9200

Receipt

No: 4255899

<b>Transaction #:</b> 4371442	
<b>Date of Transaction:</b> 09/04/2018	
CUSTOMER:	
PANOS D GIANNEOTIS 16772 W. BELL RD #110 SURPRISE, AZ 85374 US	

LINE #	QTY	DESCRIPTION	REMARKS	UNIT PRICE	TOTAL
1	1.00	LOCATABLE MINERALS / MINING CLAIMS-NOT NEW-UNADJUD, ONE AUTH NO. ONLY / MINING CLAIM MONEY RECEIVED CASES: AMC438984/\$4960.00		- n/a -	4960.00
<b>TOTAL:</b>					<b>\$4,960.00</b>

PAYMENT INFORMATION			
NOTE: Items will appear on credit card statement as "BLM O Mining Claim".			
1	AMOUNT:	4960.00	POSTMARKED: N/A
	TYPE:	CREDIT CARD	RECEIVED: 09/04/2018
	NAME:	PANOS D GIANNEOTIS 16772 W. BELL RD #110 SURPRISE AZ 85374 US	
	CARD NO:	XXXXXXXXXXXX8243	AUTH CODE: 067955
	NAME ON CARD:	PANOS D GIANNEOTIS	
	SIGNATURE:		

REMARKS

This receipt was generated by the automated BLM Collections and Billing System and is a paper representation of a portion of the official electronic record contained therein.

AMC 438984

**MAINTENANCE FEE PAYMENT**

Claimant Name: GRAND CANYON GOLD CORP  
Address: 16777 W. Bell RD # 110-417  
City: Surprise State: AZ Zip: 85374  
Telephone: 310-365-0783  
E-mail address: ceo@GrandCanyonGold.com  
Signature: [Signature]

RECEIVED  
BLM STATE OFFICE  
2017 AUG 29 P 12:46  
PHOENIX, ARIZONA  
BLM Date Stamp

Check here if this is a change of address.

LINE NO.	AMC NUMBER	CLAIM/SITE NAME	COUNTY RECORDER DATA (If available)	TWP	RNG	SEC
1		See ATTACHED				
2						
3						
4						
5						
6						
7						
8						
9						
10						

List additional claims on Form MCF114.

Bureau of Land Management  
Arizona State Office  
[www.blm.gov/az/](http://www.blm.gov/az/)

No. of Claims\*: 16 x \$155 = 4960  
Check No: 2631 Init. [Signature]  
Receipt No.: 3964676  
For BLM Use Only

\* \$155 per lode mining claim, mill site, or tunnel site; and \$155 for each 20 acres or portion thereof for each placer mining claim.

Form: MCF112  
Revised July 2014

This form is available from the Arizona Geological Survey and may be reproduced.

ENTERED  
AUG 30 2017  
BY: [Signature]

**SUPPLEMENTAL ATTACHMENT**

May be used with the following forms for listing additional mining claims:

Check One.

- Affidavit of Performance of Annual Work
- Maintenance Fee Payment
- Notice of Intent to Hold Mining Claims
- Notice of Non-Liability for Labor and Materials Furnished
- Quit claim Deed

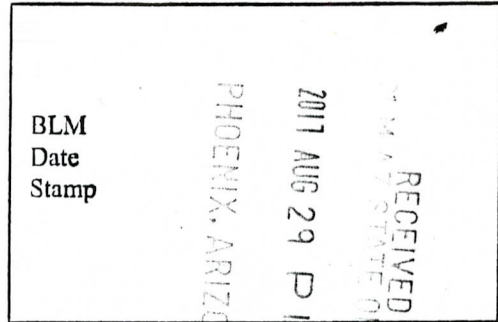

LINE NO.	AMC NUMBER	CLAIM/SITE NAME	COUNTY RECORDER DATA (If available)	TWP	RNG	SEC

Form MCF114  
Revised July 2014

This form is available from the Arizona Geological Survey and may be reproduced.

Grand Canyon Gold Corp P-7 through P15 Maintenance fee Payment

Serial Number	Claim Name	Amount Due	MTRS
AMC438984	P7	310.00	14/0030N/0180W/007
AMC438985	P7-1	310.00	14/0030N/0180W/007
AMC438986	P7-2	310.00	14/0030N/0180W/007
AMC438987	P7-3	310.00	14/0030N/0180W/007
AMC438988	P7-4	310.00	14/0030N/0180W/007
AMC438989	P7-5	310.00	14/0030N/0180W/007
AMC438990	P7-6	310.00	14/0030N/0180W/007
AMC438991	P7-7	310.00	14/0030N/0180W/007
AMC438992	P7-8	310.00	14/0030N/0180W/007
AMC438993	P7-9	310.00	14/0030N/0180W/007
AMC438994	P7-10	310.00	14/0030N/0180W/007
AMC438995	P7-11	310.00	14/0030N/0180W/007
AMC438996	P7-12	310.00	14/0030N/0180W/007
AMC438997	P7-13	310.00	14/0030N/0180W/007
AMC438998	P7-14	310.00	14/0030N/0180W/007
AMC438999	P7-15	310.00	14/0030N/0180W/007

**Total Due \$4,960.00**

RECEIVED  
STATE OFFICE  
2011 AUG 29 P 12:42  
PHOENIX, ARIZONA

**United States Department of the Interior**  
**Bureau of Land Management**  
 DIV OF LANDS, MINRLS & ENERGY  
 ONE N CENTRAL AVE  
 PHOENIX, AZ 85004 -4427  
 Phone: 602-417-9200

Receipt

No: 3964676

<b>Transaction #:</b> 4074552	
<b>Date of Transaction:</b> 08/29/2017	
<b>CUSTOMER:</b>	
GRAND CANYON GOLD CORP 16772 W BELL RD # 110-417 SURPRISE,AZ 85374-9702 US	

LINE #	QTY	DESCRIPTION	REMARKS	UNIT PRICE	TOTAL
1	1.00	LOCATABLE MINERALS / MINING CLAIMS- NOT NEW-UNADJUD,ONE AUTH NO. ONLY / MINING CLAIM MONEY RECEIVED <b>CASES: AMC438984/\$4960.00</b>	2018 MAINT/16	- n/a -	4960.00
<b>TOTAL:</b>					<b>\$4,960.00</b>

PAYMENT INFORMATION			
1	AMOUNT:	4960.00	POSTMARKED: N/A
	TYPE:	CHECK	RECEIVED: 08/29/2017
	CHECK NO:	2631	
	NAME:	GRAND CANYON GOLD CORP 16772 W BELL RD # 110-417 SURPRISE AZ 85374-9702 US	

REMARKS

This receipt was generated by the automated BLM Collections and Billing System and is a paper representation of a portion of the official electronic record contained therein.



**NOTICE!!**

**These documents have been scanned!**

**Do not place un-scanned documents beneath this notice!**

**Do not remove this notice from this file!**

GPO Jacket No. 560-102  
Print Order 61540  
Rise Business Services, LLC  
Job=AZ15 6/24/2019



Box Number= AZ15126



Claim Begin-End: AMC438984-AMC438999

**5 Miscellaneous**



AZ15126-15

AMC428281-AMC452898

**NO  
DOCUMENTS  
FOUND**

NO DOCUMENTS FOUND  
NO DOCUMENTS FOUND

**NOTICE!!**

**These documents have been scanned!**

**Do not place un-scanned documents beneath this notice!**

**Do not remove this notice from this file!**

GPO Jacket No. 560-102  
Print Order 61540  
Rise Business Services, LLC  
Job=AZ15 6/24/2019



Box Number= AZ15126



Claim Begin-End: AMC438984-AMC438999

**6 Location Notices-Amendments and Supporting Documents**



AZ15126-15

AMC428281-AMC452898

# MINING CLAIM STATUS REPORT

Data Entered: 08/24/16 RAM

MTP Checked By: [Signature]  
GEO Checked By: [Signature]

LEAD SERIAL NUMBER: AMC 438984 thru AMC 438999

### NUMBER OF CLAIMS & TYPE:

LODE \_\_\_\_\_  
PLACER \_\_\_\_\_  
16 ASSOCIATION PLACER  
MILL SITE \_\_\_\_\_  
TUNNEL SITE \_\_\_\_\_

### CHARGES:

Location Fee @ \$37 = \$ 592  
Processing Fee @ \$20 = \$ 320  
Maintenance Fee @ \$155 = \$ 2480  
Add'l Maint Fee for Assoc Placer = \$ 2480  
SUBTOTAL \$ 5872  
2017 Maint Fees  
Other Fees \$ 4960  
Other Fees \$ \_\_\_\_\_  
TOTAL \$ 10,832

TOTAL ACREAGE: \_\_\_\_\_ Per Claim  
(Placer Only)

NUMBER OF LOCATORS: \_\_\_\_\_

DOCUMENTS RECEIVED VIA: Over-the-Counter  Mail  TIMELY FILED: Yes  No  - 89th day

LEGAL DESCRIPTION: T 3N R 18W SEC 7  
T \_\_\_\_\_ R \_\_\_\_\_ SEC \_\_\_\_\_  
T \_\_\_\_\_ R \_\_\_\_\_ SEC \_\_\_\_\_  
T \_\_\_\_\_ R \_\_\_\_\_ SEC \_\_\_\_\_  
T \_\_\_\_\_ R \_\_\_\_\_ SEC \_\_\_\_\_

BLM  FOREST SERVICE  SUBJ TO PL 359: Yes  No   
WILDERNESS AREA

SPLIT ESTATE: N/A  SX  PX  OTHER   
SRHA  Was proper Notice filed if located on SHRA Land? Yes  No

RECONVEYED MINERALS ON BLM LAND REQUIRE OPENING ORDER FROM 1944 TO 1993:  
Open to Entry On \_\_\_\_\_ N/A

COMMENTS/STATUS: VOID  PARTIALLY VOID  PVT MINERALS  WITHDRAWN LANDS   
OTHER  \_\_\_\_\_  
\_\_\_\_\_  
\_\_\_\_\_

Claimant acknowledges that portions of the following claim(s) site(s) may be void or voidable.

Printed Name of Claimant \_\_\_\_\_ Signature of Claimant \_\_\_\_\_

\*\*\*\*\*FINAL ADJUDICATION\*\*\*\*\*

DATE 2/23/17 INITIALS MB

AMC 438984

County Recorder Space:

Grand Canyon Gold Corp  
16772 W. Bell Rd #110-417  
Surprise, AZ 85374  
(310)-365-0783



2016-02706  
Page 1 of 2  
Requested By: Grand Canyon Gold Corp  
SHELLY D BAKER, RECORDER  
OFFICIAL RECORDS OF LA PAZ COUNTY, AZ  
07-20-2016 11:40 AM Recording Fee \$10.00

## LOCATION NOTICE PLACER MINING CLAIM

NOTICE IS HEREBY GIVEN that the **P7** placer mining claim has been

Located by Grand Canyon Gold Corp, whose current mailing address is; 16772 W. Bell RD #110-417, Surprise, AZ 85374, and Denise E. Gianneotis whose current mailing address is: 16772 W. Bell Rd #110-417 Surprise, AZ 85374

The general course of the claim is east to west and is situated in La Paz County, Arizona.

This claim is 1320' feet in length and 1320' feet in width. This claim runs from the location monument on which this location notice is posted. This claim is marked by four monuments, one at each corner of the claim. The location monument on which this Notice is posted is situated within:

Township 3 North, Range 18 West, Section 7, Quarter Section: NW ¼ NW ¼

La Paz County, Arizona. Gila & Salt River Base and Meridian. This claim is 40 acres in size.

AMC 438984 P-7  
WITHIN LOT #1

The locality of this claim with reference to some natural object or permanent monument and additional information (if any) concerning its locality is as follows: Section Marker and natural stone with wood post.

Dated and posted on the ground this 15<sup>TH</sup> day of May, 2016.

Grand Canyon Gold Corp:   
Panos D. Gianneotis-CEO

Denise E. Gianneotis.:   
Denise E. Gianneotis-

PHOENIX, ARIZONA

2016 AUG 12 A 10:09

RECEIVED  
BLM AZ STATE OFFICE

AMC 438984

N  
**MINING CLAIM MAP**

Lode ( ) Placer (X)  
Mill-site ( )

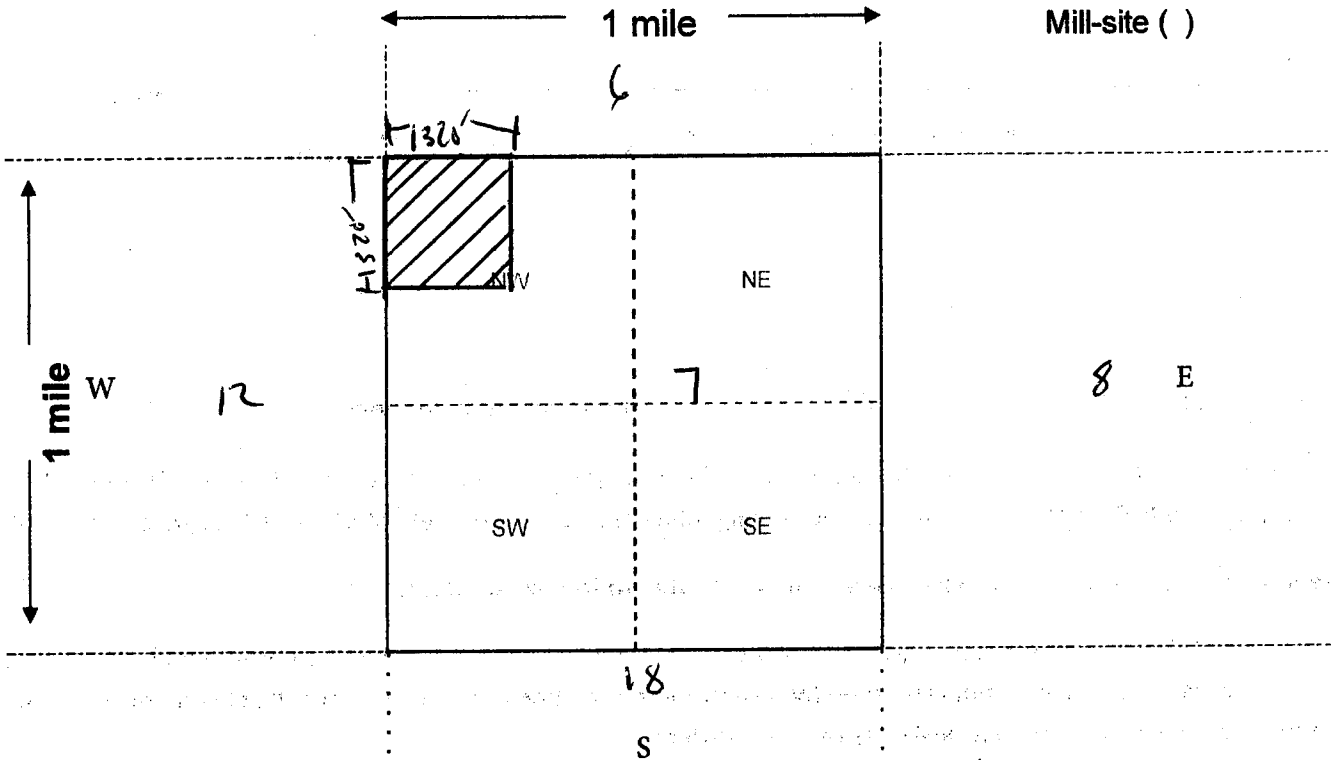

Scale: 1" = 2000 feet



1. The above map depicts the P7 mining claim, which is located in Section (s) 7, Township 3 N, Range 18W, Gila and Salt River Base and Meridian, La Paz County, Arizona. Total claim acreage is 40

2. The type of corner and location monuments used are as follows: 2 X 2 Wood Post

3. The bearings and distances in degrees and feet between claim corners and to a public land survey monument are as depicted on the map.

4. If the claim is a placer or mill-site claim with exterior limits conforming to legal subdivisions of the public survey, provide a legal description of the claim NW 1/4 NW 1/4

County Recorder Space:

Grand Canyon Gold Corp  
16772 W. Bell Rd #110-417  
Surprise, AZ 85374  
(310)-365-0783



2016-02707  
Page 1 of 2  
Requested By: Grand Canyon Gold Corp  
SHELLY D BAKER, RECORDER  
OFFICIAL RECORDS OF LA PAZ COUNTY, AZ  
07-20-2016 11:40 AM Recording Fee \$10.00

## LOCATION NOTICE PLACER MINING CLAIM

NOTICE IS HEREBY GIVEN that the **P7-1** placer mining claim has been

Located by Grand Canyon Gold Corp, whose current mailing address is; 16772 W. Bell RD #110-417, Surprise, AZ 85374, and Denise E. Gianneotis whose current mailing address is: 16772 W. Bell Rd #110-417 Surprise, AZ 85374

The general course of the claim is east to west and is situated in La Paz County, Arizona.

This claim is 1320' feet in length and 1320' feet in width. This claim runs from the location monument on which this location notice is posted. This claim is marked by four monuments, one at each corner of the claim. The location monument on which this Notice is posted is situated within:

Township 3 North, Range 18 West, Section 7, Quarter Section: NE ¼ NW ¼

La Paz County, Arizona. Gila & Salt River Base and Meridian. This claim is 40 acres in size.

The locality of this claim with reference to some natural object or permanent monument and additional information (if any) concerning its locality is as follows: Section Marker and natural stone with wood post.

Dated and posted on the ground this 15<sup>TH</sup> day of May, 2016.

Grand Canyon Gold Corp:

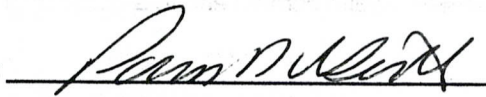
  
Panos D. Gianneotis-CEO

Denise E. Gianneotis.:

  
Denise E. Gianneotis-

PHOENIX, ARIZONA

2016 AUG 12 A 10:09

RECEIVED  
BLM AZ STATE OFFICE

AHC438985

N  
**MINING CLAIM MAP**

Lode ( ) Placer (X)  
Mill-site ( )

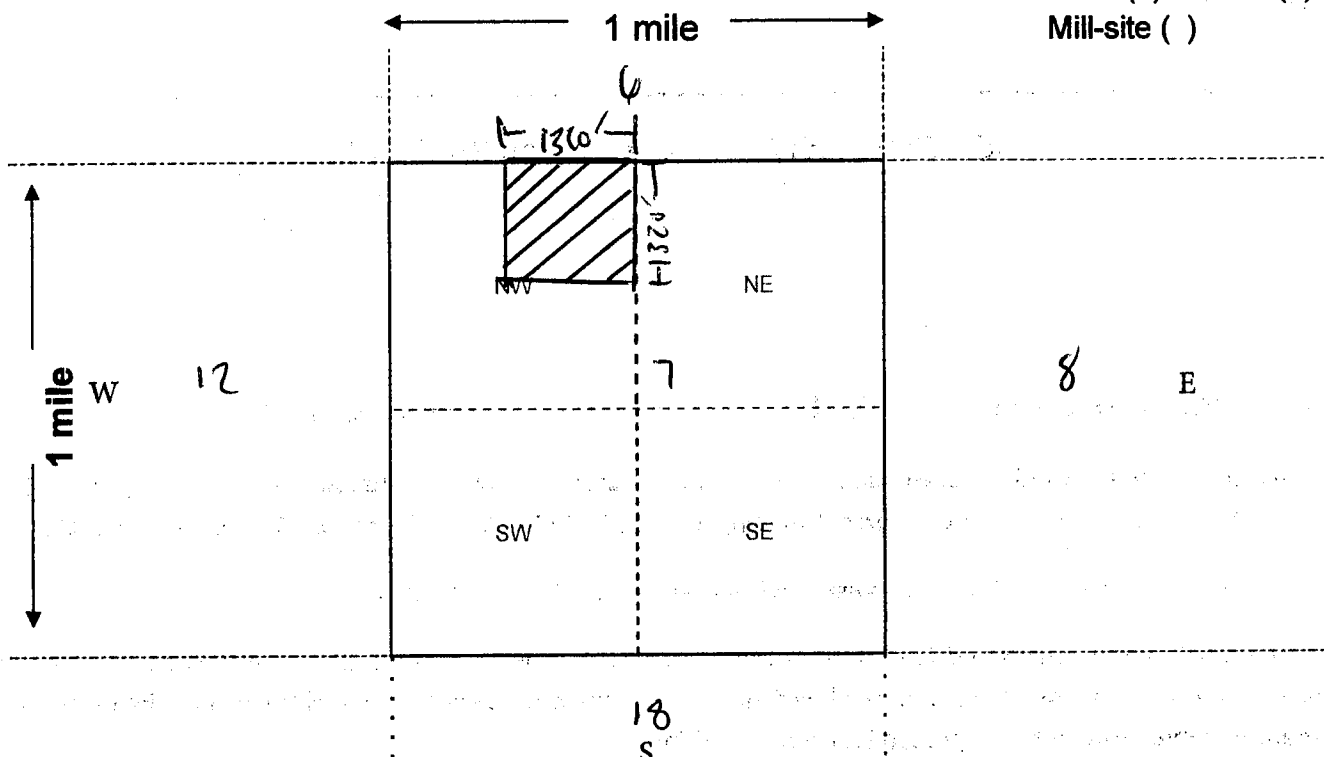

Scale: 1" = 2000 feet



1. The above map depicts the P7-1 mining claim, which is located in Section (s) 7, Township 3 N, Range 18W, Gila and Salt River Base and Meridian, La Paz County, Arizona. Total claim acreage is 40

2. The type of corner and location monuments used are as follows: 2 X 2 Wood Post

3. The bearings and distances in degrees and feet between claim corners and to a public land survey monument are as depicted on the map.

4. If the claim is a placer or mill-site claim with exterior limits conforming to legal subdivisions of the public survey, provide a legal description of the claim NE 1/4 NW 1/4



County Recorder Space:

Grand Canyon Gold Corp  
16772 W. Bell Rd #110-417  
Surprise, AZ 85374  
(310)-365-0783



2016-02708  
Page 1 of 2  
Requested By: Grand Canyon Gold Corp  
SHELLY D BAKER, RECORDER  
OFFICIAL RECORDS OF LA PAZ COUNTY, AZ  
07-20-2016 11:40 AM Recording Fee \$10.00

## LOCATION NOTICE PLACER MINING CLAIM

NOTICE IS HEREBY GIVEN that the **P7-2** placer mining claim has been

Located by Grand Canyon Gold Corp, whose current mailing address is; 16772 W. Bell RD #110-417, Surprise, AZ 85374, and Denise E. Gianneotis whose current mailing address is: 16772 W. Bell Rd #110-417 Surprise, AZ 85374

The general course of the claim is east to west and is situated in La Paz County, Arizona.

This claim is 1320' feet in length and 1320' feet in width. This claim runs from the location monument on which this location notice is posted. This claim is marked by four monuments, one at each corner of the claim. The location monument on which this Notice is posted is situated within:

Township 3 North, Range 18 West, Section 7, Quarter Section: SE ¼ NW ¼

La Paz County, Arizona. Gila & Salt River Base and Meridian. This claim is 40 acres in size.

The locality of this claim with reference to some natural object or permanent monument and additional information (if any) concerning its locality is as follows: Section Marker and natural stone with wood post.

Dated and posted on the ground this 15<sup>TH</sup> day of May, 2016.

Grand Canyon Gold Corp:

Panos D. Gianneotis-CEO

Denise E. Gianneotis:

Denise E. Gianneotis-

PHOENIX, ARIZONA

2016 AUG 12 A 10:09

RECEIVED  
BLM AZ STATE OFFICE

ANCH 38986

N  
**MINING CLAIM MAP**

Lode ( ) Placer (X)  
Mill-site ( )

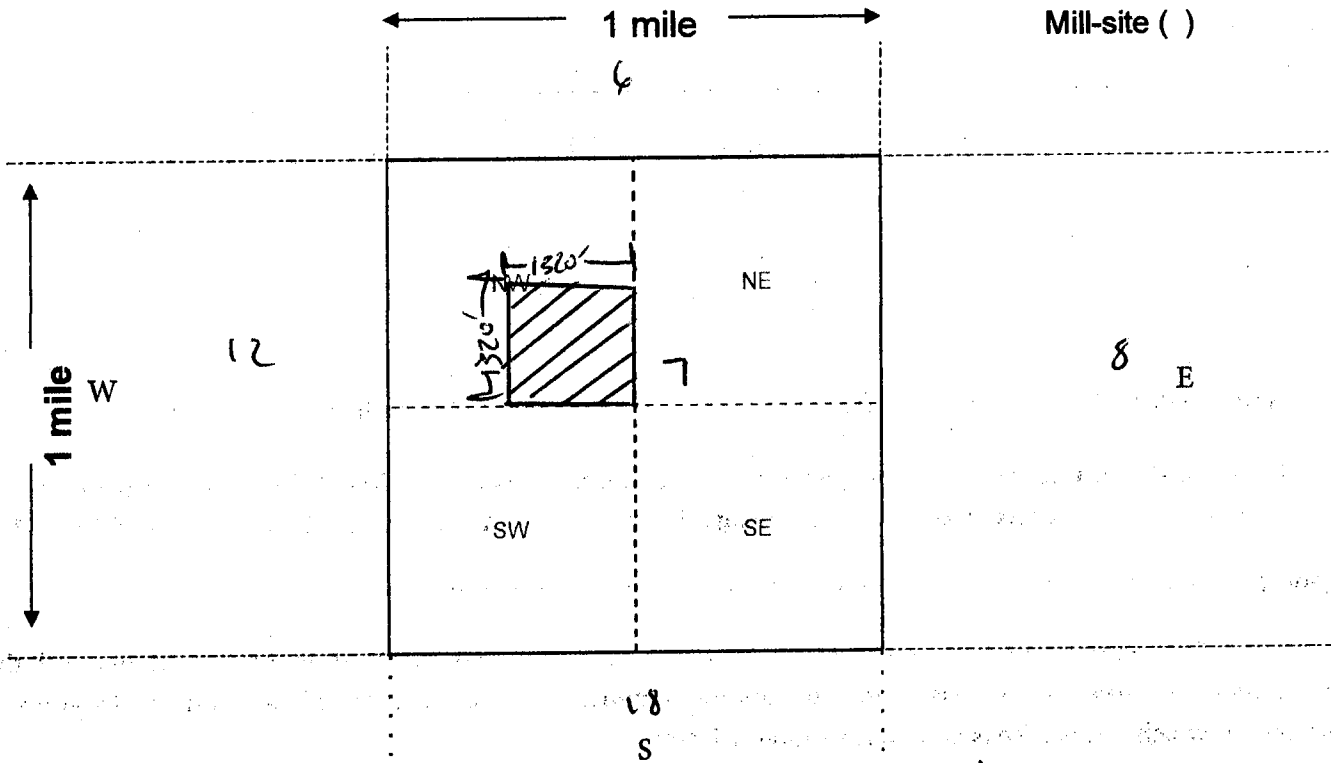

Scale: 1" = 2000 feet



1. The above map depicts the P7-2 mining claim, which is located in Section (s) 7, Township 3 N, Range 18W, Gila and Salt River Base and Meridian, La Paz County, Arizona. Total claim acreage is 40

2. The type of corner and location monuments used are as follows: 2 X 2 Wood Post

3. The bearings and distances in degrees and feet between claim corners and to a public land survey monument are as depicted on the map.

4. If the claim is a placer or mill-site claim with exterior limits conforming to legal subdivisions of the public survey, provide a legal description of the claim SE 1/4 NW 1/4

County Recorder Space:

Grand Canyon Gold Corp  
16772 W. Bell Rd #110-417  
Surprise, AZ 85374  
(310)-365-0783



2016-02709  
Page 1 of 2  
Requested By: Grand Canyon Gold Corp  
SHELLY D BAKER, RECORDER  
OFFICIAL RECORDS OF LA PAZ COUNTY, AZ  
07-20-2016 11:40 AM Recording Fee \$10.00

## LOCATION NOTICE PLACER MINING CLAIM

NOTICE IS HEREBY GIVEN that the **P7-3** placer mining claim has been

Located by Grand Canyon Gold Corp, whose current mailing address is; 16772 W. Bell RD #110-417, Surprise, AZ 85374, and Denise E. Gianneotis whose current mailing address is: 16772 W. Bell Rd #110-417 Surprise, AZ 85374

The general course of the claim is east to west and is situated in La Paz County, Arizona.

This claim is 1320' feet in length and 1320' feet in width. This claim runs from the location monument on which this location notice is posted. This claim is marked by four monuments, one at each corner of the claim. The location monument on which this Notice is posted is situated within:

Township 3 North, Range 18 West, Section 7, Quarter Section: SW ¼ NW ¼

La Paz County, Arizona. Gila & Salt River Base and Meridian. This claim is 40 acres in size.

*Amc 438987 P7-3  
WITH IN LOT #2*

The locality of this claim with reference to some natural object or permanent monument and additional information (if any) concerning its locality is as follows: Section Marker and natural stone with wood post.

Dated and posted on the ground this 15<sup>TH</sup> day of May, 2016.

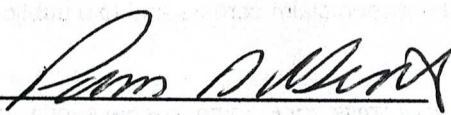
Grand Canyon Gold Corp:   
Panos D. Gianneotis-CEO

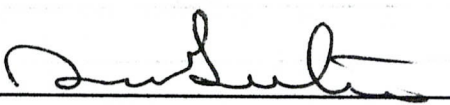
Denise E. Gianneotis:   
Denise E. Gianneotis-

RECEIVED  
BLM AZ STATE OFFICE  
2016 AUG 12 A 10:09  
PHOENIX, ARIZONA

AMC 438987

N

### MINING CLAIM MAP

Lode ( ) Placer (X)  
Mill-site ( )

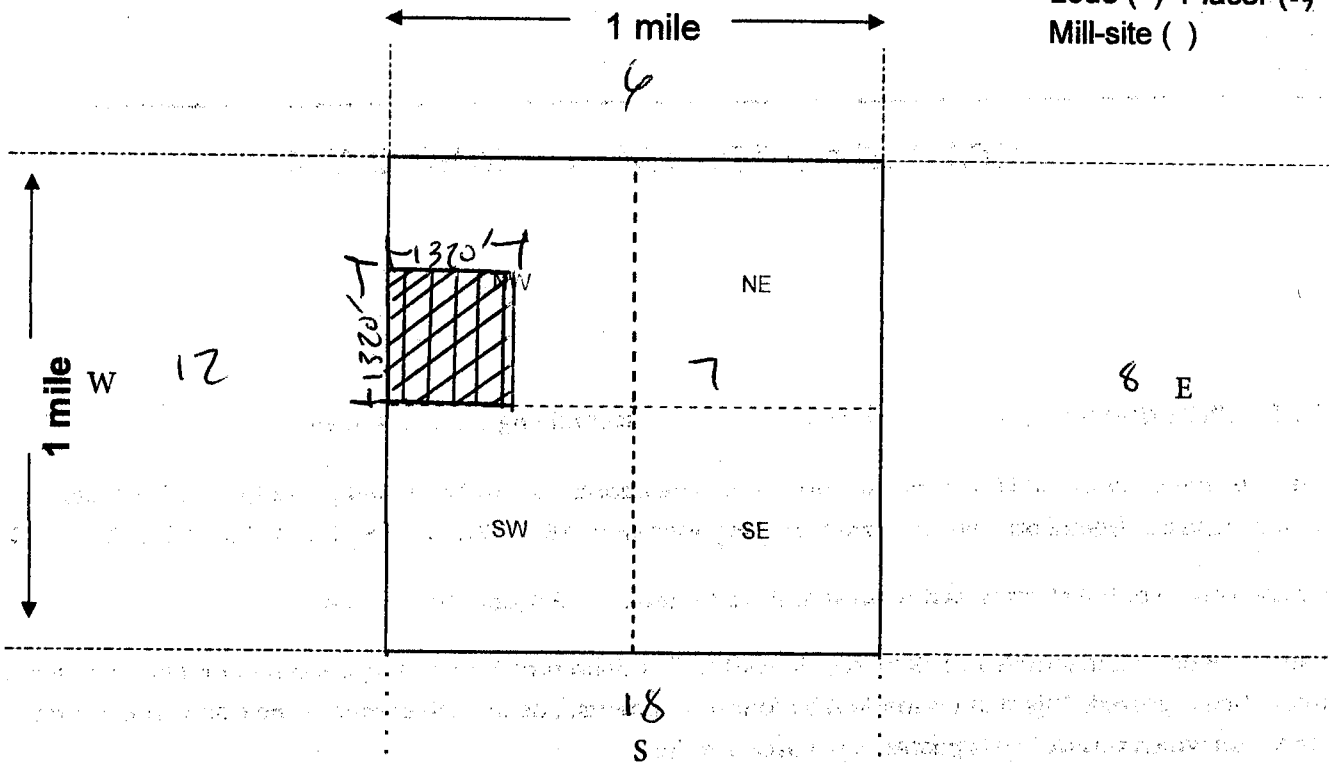

Scale: 1" = 2000 feet



1. The above map depicts the P7-3 mining claim, which is located in Section (s) 7, Township 3 N, Range 18W, Gila and Salt River Base and Meridian, La Paz County, Arizona. Total claim acreage is 40

2. The type of corner and location monuments used are as follows: 2 X 2 Wood Post

3. The bearings and distances in degrees and feet between claim corners and to a public land survey monument are as depicted on the map.

4. If the claim is a placer or mill-site claim with exterior limits conforming to legal subdivisions of the public survey, provide a legal description of the claim SW 1/4 NW 1/4

County Recorder Space:

Grand Canyon Gold Corp  
16772 W. Bell Rd #110-417  
Surprise, AZ 85374  
(310)-365-0783



2016-02710  
Page 1 of 2  
Requested By: Grand Canyon Gold Corp  
SHELLY D BAKER, RECORDER  
OFFICIAL RECORDS OF LA PAZ COUNTY, AZ  
07-20-2016 11:40 AM Recording Fee \$10.00

## LOCATION NOTICE PLACER MINING CLAIM

NOTICE IS HEREBY GIVEN that the **P7-4** placer mining claim has been

Located by Grand Canyon Gold Corp, whose current mailing address is; 16772 W. Bell RD #110-417, Surprise, AZ 85374, and Denise E. Gianneotis whose current mailing address is: 16772 W. Bell Rd #110-417 Surprise, AZ 85374

The general course of the claim is east to west and is situated in La Paz County, Arizona.

This claim is 1320' feet in length and 1320' feet in width. This claim runs from the location monument on which this location notice is posted. This claim is marked by four monuments, one at each corner of the claim. The location monument on which this Notice is posted is situated within:

Township 3 North, Range 18 West, Section 7, Quarter Section: NW ¼ NE ¼

La Paz County, Arizona. Gila & Salt River Base and Meridian. This claim is 40 acres in size.

The locality of this claim with reference to some natural object or permanent monument and additional information (if any) concerning its locality is as follows: Section Marker and natural stone with wood post.

Dated and posted on the ground this 15<sup>TH</sup> day of May, 2016.

Grand Canyon Gold Corp:

Panos D. Gianneotis-CEO

Denise E. Gianneotis:

Denise E. Gianneotis-

AHC438988

PHOENIX, ARIZONA

2016 AUG 12 A 10:09

RECEIVED  
BLM AZ STATE OFFICE

N  
**MINING CLAIM MAP**

Lode ( ) Placer (X)  
Mill-site ( )

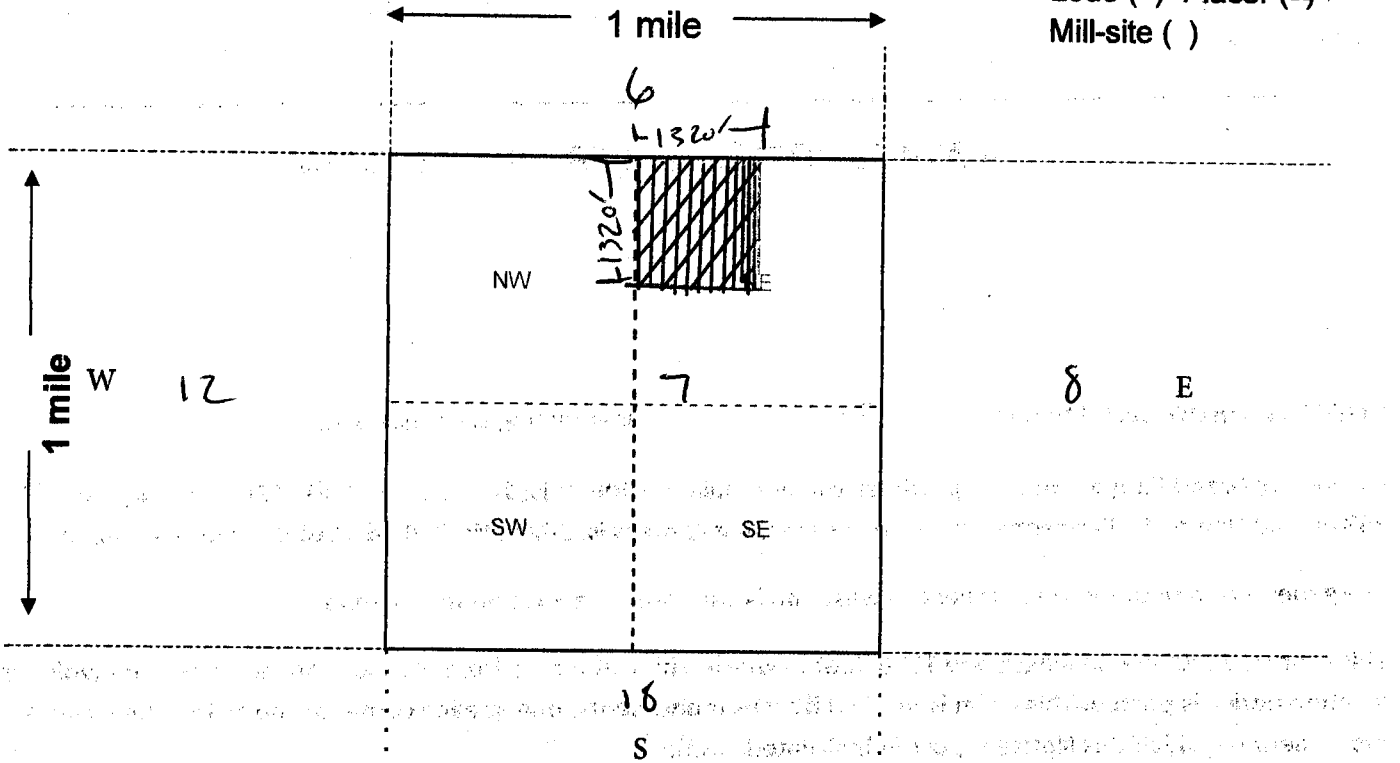

Scale: 1" = 2000 feet



1. The above map depicts the P7-4 mining claim, which is located in Section (s) 7, Township 3 N, Range 18W, Gila and Salt River Base and Meridian, La Paz County, Arizona. Total claim acreage is 40
2. The type of corner and location monuments used are as follows: 2 X 2 Wood Post
3. The bearings and distances in degrees and feet between claim corners and to a public land survey monument are as depicted on the map.
4. If the claim is a placer or mill-site claim with exterior limits conforming to legal subdivisions of the public survey, provide a legal description of the claim NW 1/4 NE 1/4

County Recorder Space:

Grand Canyon Gold Corp  
16772 W. Bell Rd #110-417  
Surprise, AZ 85374  
(310)-365-0783



2016-02711

Page 1 of 2

Requested By: Grand Canyon Gold Corp  
SHELLY D BAKER, RECORDER  
OFFICIAL RECORDS OF LA PAZ COUNTY, AZ  
07-20-2016 11:40 AM Recording Fee \$10.00

## LOCATION NOTICE PLACER MINING CLAIM

NOTICE IS HEREBY GIVEN that the **P7-5** placer mining claim has been

Located by Grand Canyon Gold Corp, whose current mailing address is; 16772 W. Bell RD #110-417, Surprise, AZ 85374, and Denise E. Gianneotis whose current mailing address is: 16772 W. Bell Rd #110-417 Surprise, AZ 85374

The general course of the claim is east to west and is situated in La Paz County, Arizona.

This claim is 1320' feet in length and 1320' feet in width. This claim runs from the location monument on which this location notice is posted. This claim is marked by four monuments, one at each corner of the claim. The location monument on which this Notice is posted is situated within:

Township 3 North, Range 18 West, Section 7, Quarter Section: NE ¼ NE ¼

La Paz County, Arizona. Gila & Salt River Base and Meridian. This claim is 40 acres in size.

The locality of this claim with reference to some natural object or permanent monument and additional information (if any) concerning its locality is as follows: Section Marker and natural stone with wood post.

Dated and posted on the ground this 15<sup>TH</sup> day of May, 2016.

Grand Canyon Gold Corp:

  
Panos D. Gianneotis-CEO

Denise E. Gianneotis:

  
Denise E. Gianneotis-

PHOENIX, ARIZONA

2016 AUG 12 A 10:10

RECEIVED  
BLM AZ STATE OFFICE

AHC438989

**MINING CLAIM MAP**

Lode ( ) Placer (X)  
Mill-site ( )

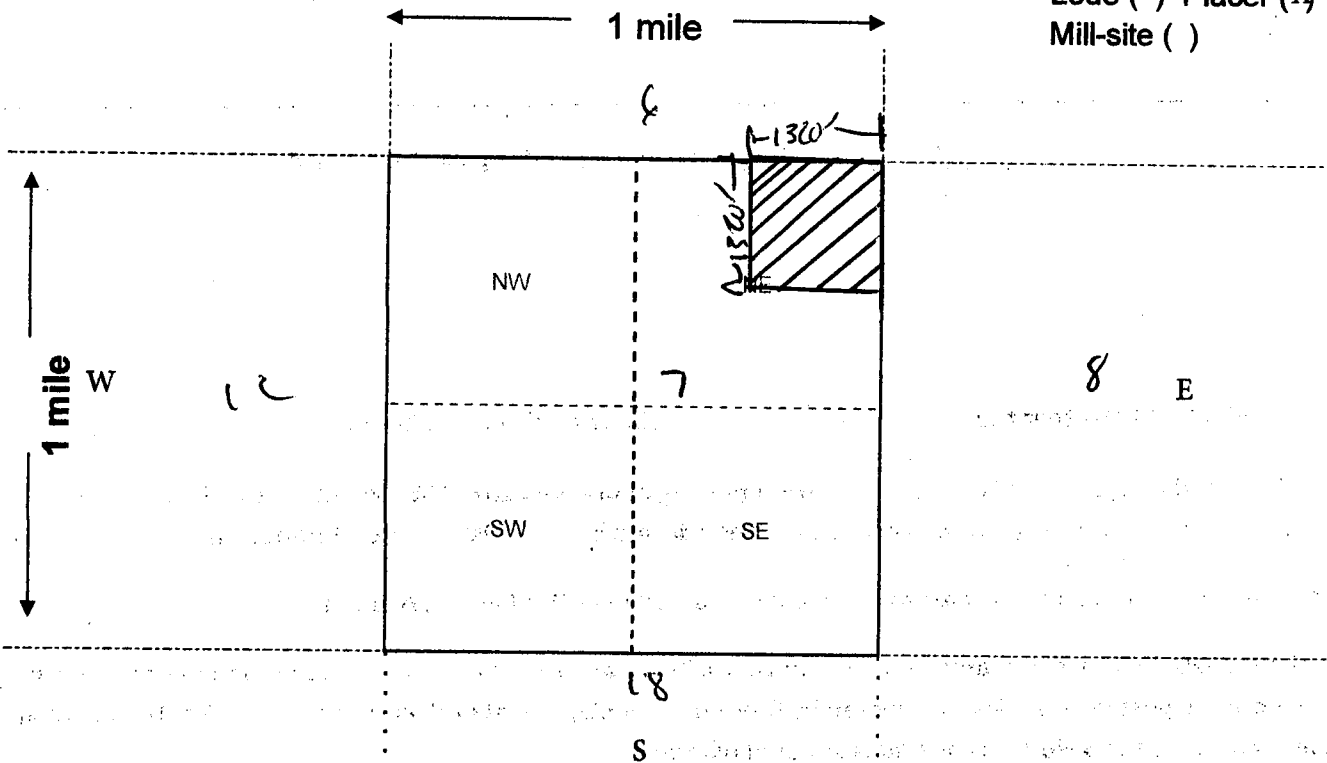

Scale: 1" = 2000 feet



1. The above map depicts the P7-S mining claim, which is located in Section (s) 7, Township 3 N, Range 18W, Gila and Salt River Base and Meridian, La Paz County, Arizona. Total claim acreage is 40

2. The type of corner and location monuments used are as follows: 2 X 2 Wood Post

3. The bearings and distances in degrees and feet between claim corners and to a public land survey monument are as depicted on the map.

4. If the claim is a placer or mill-site claim with exterior limits conforming to legal subdivisions of the public survey, provide a legal description of the claim NE 1/4 NE 1/4



County Recorder Space:

Grand Canyon Gold Corp  
16772 W. Bell Rd #110-417  
Surprise, AZ 85374  
(310)-365-0783



2016-02712  
Page 1 of 2  
Requested By: Grand Canyon Gold Corp  
SHELLY D BAKER, RECORDER  
OFFICIAL RECORDS OF LA PAZ COUNTY, AZ  
07-20-2016 11:40 AM Recording Fee \$10.00

## LOCATION NOTICE PLACER MINING CLAIM

NOTICE IS HEREBY GIVEN that the **P7-6** placer mining claim has been

Located by Grand Canyon Gold Corp, whose current mailing address is; 16772 W. Bell RD #110-417, Surprise, AZ 85374, and Denise E. Gianneotis whose current mailing address is: 16772 W. Bell Rd #110-417 Surprise, AZ 85374

The general course of the claim is east to west and is situated in La Paz County, Arizona.

This claim is 1320' feet in length and 1320' feet in width. This claim runs from the location monument on which this location notice is posted. This claim is marked by four monuments, one at each corner of the claim. The location monument on which this Notice is posted is situated within:

Township 3 North, Range 18 West, Section 7, Quarter Section: SE ¼ NE ¼

La Paz County, Arizona. Gila & Salt River Base and Meridian. This claim is 40 acres in size.

The locality of this claim with reference to some natural object or permanent monument and additional information (if any) concerning its locality is as follows: Section Marker and natural stone with wood post.

Dated and posted on the ground this 15<sup>TH</sup> day of May, 2016.

Grand Canyon Gold Corp:   
Panos D. Gianneotis-CEO

Denise E. Gianneotis:   
Denise E. Gianneotis-

RECEIVED  
BLM AZ STATE OFFICE  
2016 AUG 12 A 10:10  
PHOENIX, ARIZONA

ANCH38990

N  
**MINING CLAIM MAP**

Lode ( ) Placer (X)  
Mill-site ( )

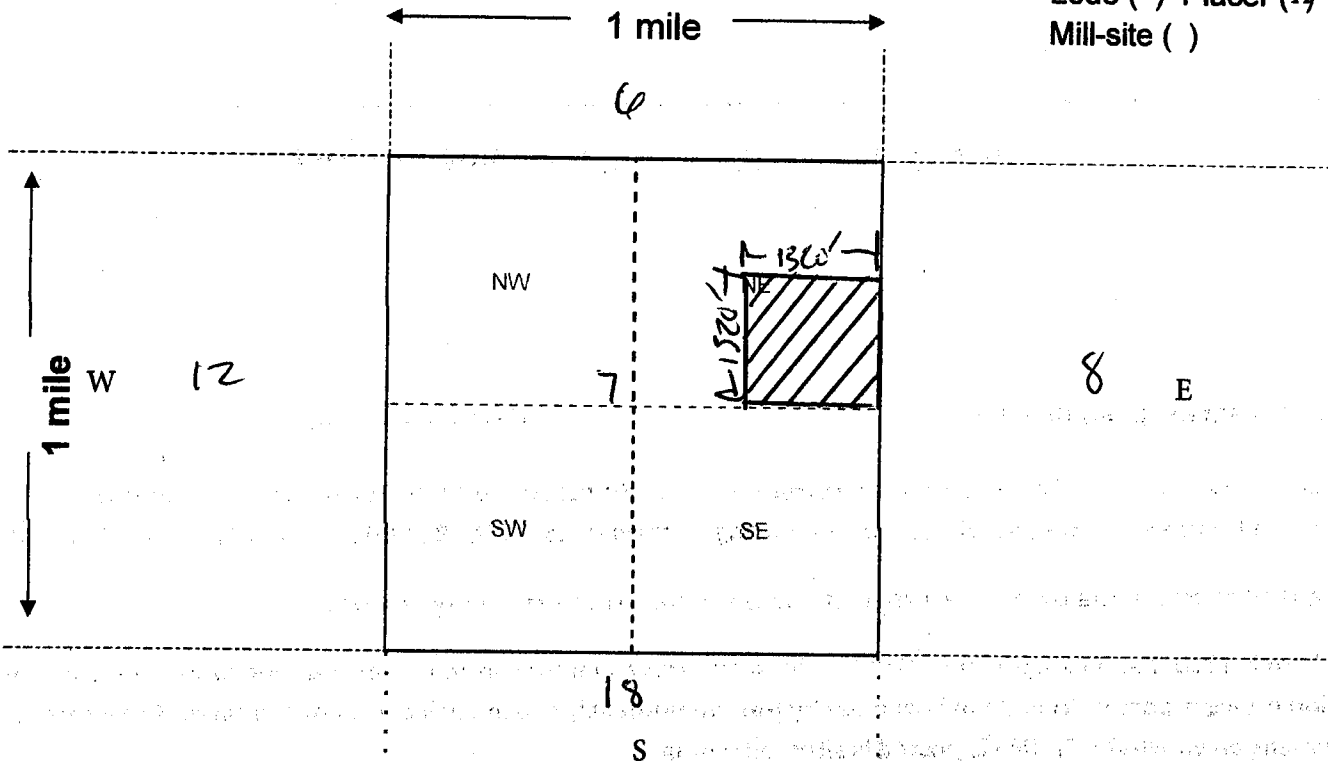

Scale: 1" = 2000 feet



1. The above map depicts the P7-6 mining claim, which is located in Section (s) 7, Township 3 N, Range 18W, Gila and Salt River Base and Meridian, La Paz County, Arizona. Total claim acreage is 40
2. The type of corner and location monuments used are as follows: 2 X 2 Wood Post
3. The bearings and distances in degrees and feet between claim corners and to a public land survey monument are as depicted on the map.
4. If the claim is a placer or mill-site claim with exterior limits conforming to legal subdivisions of the public survey, provide a legal description of the claim SE 1/4 NE 1/4

County Recorder Space:

Grand Canyon Gold Corp  
16772 W. Bell Rd #110-417  
Surprise, AZ 85374  
(310)-365-0783



2016-02713  
Page 1 of 2  
Requested By: Grand Canyon Gold Corp  
SHELLY D BAKER, RECORDER  
OFFICIAL RECORDS OF LA PAZ COUNTY, AZ  
07-20-2016 11:40 AM Recording Fee \$10.00

## LOCATION NOTICE PLACER MINING CLAIM

NOTICE IS HEREBY GIVEN that the **P7-7** placer mining claim has been

Located by Grand Canyon Gold Corp, whose current mailing address is; 16772 W. Bell RD #110-417, Surprise, AZ 85374, and Denise E. Gianneotis whose current mailing address is: 16772 W. Bell Rd #110-417 Surprise, AZ 85374

The general course of the claim is east to west and is situated in La Paz County, Arizona.

This claim is 1320' feet in length and 1320' feet in width. This claim runs from the location monument on which this location notice is posted. This claim is marked by four monuments, one at each corner of the claim. The location monument on which this Notice is posted is situated within:

Township 3 North, Range 18 West, Section 7, Quarter Section: SW ¼ NE ¼

La Paz County, Arizona. Gila & Salt River Base and Meridian. This claim is 40 acres in size.

The locality of this claim with reference to some natural object or permanent monument and additional information (if any) concerning its locality is as follows: Section Marker and natural stone with wood post.

Dated and posted on the ground this 15<sup>TH</sup> day of May, 2016.

Grand Canyon Gold Corp:

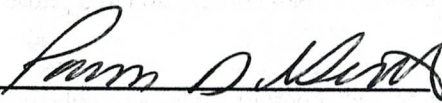
  
Panos D. Gianneotis-CEO

Denise E. Gianneotis.:

  
Denise E. Gianneotis-

PHOENIX, ARIZONA

2016 AUG 12 A 10:10

RECEIVED  
BLM AZ STATE OFFICE

AMC438991

N  
**MINING CLAIM MAP**

Lode ( ) Placer (X)  
Mill-site ( )

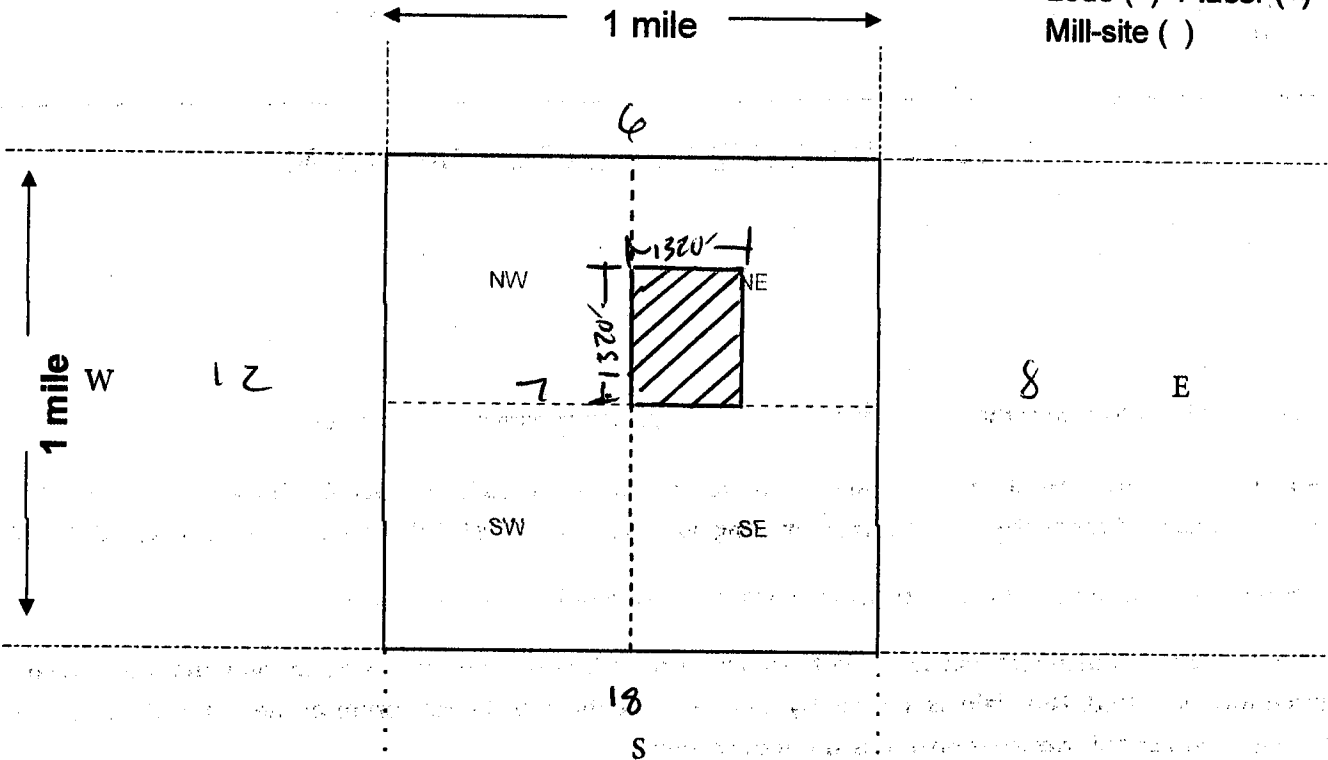

Scale: 1" = 2000 feet



1. The above map depicts the P7-7 mining claim, which is located in Section (s) 7, Township 3 N, Range 18W, Gila and Salt River Base and Meridian, La Paz County, Arizona. Total claim acreage is 40

2. The type of corner and location monuments used are as follows: 2 X 2 Wood Post

3. The bearings and distances in degrees and feet between claim corners and to a public land survey monument are as depicted on the map.

4. If the claim is a placer or mill-site claim with exterior limits conforming to legal subdivisions of the public survey, provide a legal description of the claim SW 1/4 NE 1/4



2016-02714

Page 1 of 2

Requested By: Grand Canyon Gold Corp  
SHELLY D BAKER, RECORDER  
OFFICIAL RECORDS OF LA PAZ COUNTY, AZ  
07-20-2016 11:40 AM Recording Fee \$10.00

County Recorder Space:

Grand Canyon Gold Corp  
16772 W. Bell Rd #110-417  
Surprise, AZ 85374  
(310)-365-0783

## LOCATION NOTICE PLACER MINING CLAIM

AHC438992

NOTICE IS HEREBY GIVEN that the **P7-8** placer mining claim has been

Located by Grand Canyon Gold Corp, whose current mailing address is; 16772 W. Bell RD #110-417, Surprise, AZ 85374, and Denise E. Gianneotis whose current mailing address is: 16772 W. Bell Rd #110-417 Surprise, AZ 85374

The general course of the claim is east to west and is situated in La Paz County, Arizona.

This claim is 1320' feet in length and 1320' feet in width. This claim runs from the location monument on which this location notice is posted. This claim is marked by four monuments, one at each corner of the claim. The location monument on which this Notice is posted is situated within:

Township 3 North, Range 18 West, Section 7, Quarter Section: NW ¼ SE ¼

La Paz County, Arizona. Gila & Salt River Base and Meridian. This claim is 40 acres in size.

The locality of this claim with reference to some natural object or permanent monument and additional information (if any) concerning its locality is as follows: Section Marker and natural stone with wood post.

Dated and posted on the ground this 15<sup>TH</sup> day of May, 2016.

Grand Canyon Gold Corp:

  
Panos D. Gianneotis-CEO

Denise E. Gianneotis.:

  
Denise E. Gianneotis-

RECEIVED  
BLM AZ STATE OFFICE  
2016 AUG 12 A 10:10  
PHOENIX, ARIZONA

Map on reverse side

N  
**MINING CLAIM MAP**

Lode ( ) Placer (X)  
Mill-site ( )

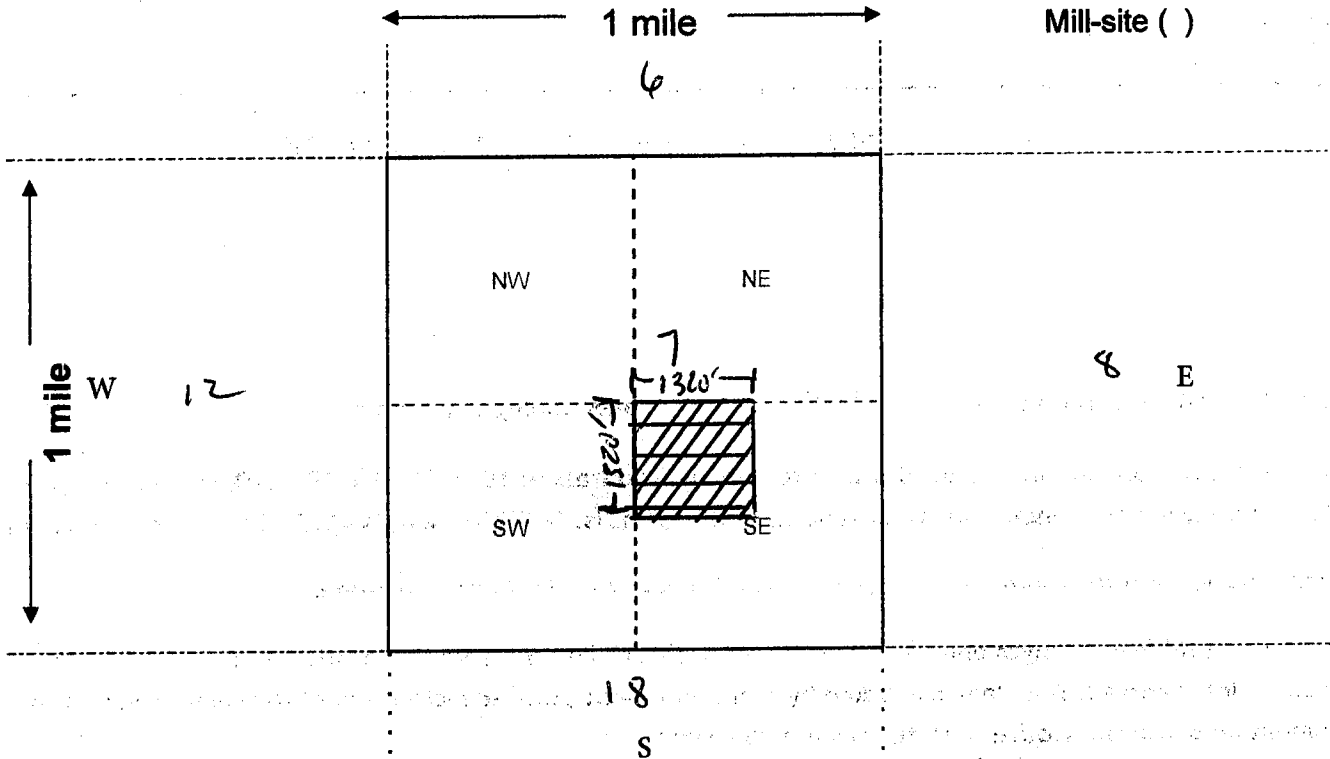

Scale: 1" = 2000 feet



1. The above map depicts the P7-8 mining claim, which is located in Section (s) 7, Township 3 N, Range 18W, Gila and Salt River Base and Meridian, La Paz County, Arizona. Total claim acreage is 40
2. The type of corner and location monuments used are as follows: 2 X 2 Wood Post
3. The bearings and distances in degrees and feet between claim corners and to a public land survey monument are as depicted on the map.
4. If the claim is a placer or mill-site claim with exterior limits conforming to legal subdivisions of the public survey, provide a legal description of the claim NW 1/4 SE 1/4

County Recorder Space:

Grand Canyon Gold Corp  
16772 W. Bell Rd #110-417  
Surprise, AZ 85374  
(310)-365-0783



2016-02715  
Page 1 of 2  
Requested By: Grand Canyon Gold Corp  
SHELLY D BAKER, RECORDER  
OFFICIAL RECORDS OF LA PAZ COUNTY, AZ  
07-20-2016 11:40 AM Recordings Fee \$10.00

## LOCATION NOTICE PLACER MINING CLAIM

NOTICE IS HEREBY GIVEN that the **P7-9** placer mining claim has been

Located by Grand Canyon Gold Corp, whose current mailing address is; 16772 W. Bell RD #110-417, Surprise, AZ 85374, and Denise E. Gianneotis whose current mailing address is: 16772 W. Bell Rd #110-417 Surprise, AZ 85374

The general course of the claim is east to west and is situated in La Paz County, Arizona.

This claim is 1320' feet in length and 1320' feet in width. This claim runs from the location monument on which this location notice is posted. This claim is marked by four monuments, one at each corner of the claim. The location monument on which this Notice is posted is situated within:

Township 3 North, Range 18 West, Section 7, Quarter Section: NE ¼ SE ¼

La Paz County, Arizona. Gila & Salt River Base and Meridian. This claim is 40 acres in size.

The locality of this claim with reference to some natural object or permanent monument and additional information (if any) concerning its locality is as follows: Section Marker and natural stone with wood post.

Dated and posted on the ground this 15<sup>TH</sup> day of May, 2016.

Grand Canyon Gold Corp:   
Panos D. Gianneotis-CEO

Denise E. Gianneotis:   
Denise E. Gianneotis-

RECEIVED  
BLM AZ STATE OFFICE  
2016 AUG 12 A 10:10  
PHOENIX, ARIZONA

AHC438993

N  
**MINING CLAIM MAP**

Lode ( ) Placer (X)  
Mill-site ( )

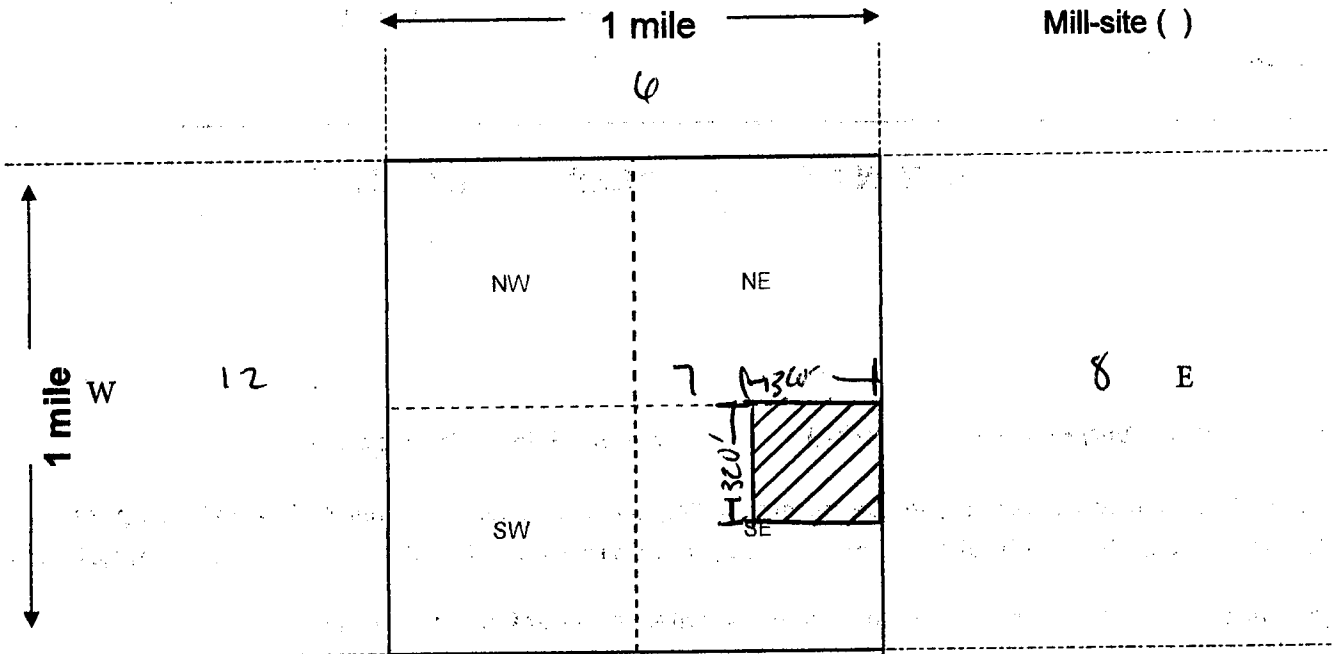

Scale: 1" = 2000 feet

1. The above map depicts the P7-9 mining claim, which is located in Section (s) 7, Township 3N, Range 18W, Gila and Salt River Base and Meridian, La Paz County, Arizona. Total claim acreage is 40

2. The type of corner and location monuments used are as follows: 2 X 2 Wood Post

3. The bearings and distances in degrees and feet between claim corners and to a public land survey monument are as depicted on the map.

4. If the claim is a placer or mill-site claim with exterior limits conforming to legal subdivisions of the public survey, provide a legal description of the claim NE 1/4 SE 1/4



County Recorder Space:

Grand Canyon Gold Corp  
16772 W. Bell Rd #110-417  
Surprise, AZ 85374  
(310)-365-0783



2016-02716  
Page 1 of 2  
Requested By: Grand Canyon Gold Corp  
SHELLY D BAKER, RECORDER  
OFFICIAL RECORDS OF LA PAZ COUNTY, AZ  
07-20-2016 11:40 AM Recording Fee \$10.00

## LOCATION NOTICE PLACER MINING CLAIM

NOTICE IS HEREBY GIVEN that the **P7-10** placer mining claim has been

Located by Grand Canyon Gold Corp, whose current mailing address is; 16772 W. Bell RD #110-417, Surprise, AZ 85374, and Denise E. Gianneotis whose current mailing address is: 16772 W. Bell Rd #110-417 Surprise, AZ 85374

The general course of the claim is east to west and is situated in La Paz County, Arizona.

This claim is 1320' feet in length and 1320' feet in width. This claim runs from the location monument on which this location notice is posted. This claim is marked by four monuments, one at each corner of the claim. The location monument on which this Notice is posted is situated within:

Township 3 North, Range 18 West, Section 7, Quarter Section: SE ¼ SE ¼

La Paz County, Arizona. Gila & Salt River Base and Meridian. This claim is 40 acres in size.

The locality of this claim with reference to some natural object or permanent monument and additional information (if any) concerning its locality is as follows: Section Marker and natural stone with wood post.

Dated and posted on the ground this 15<sup>TH</sup> day of May, 2016.

Grand Canyon Gold Corp:   
Panos D. Gianneotis-CEO

Denise E. Gianneotis:   
Denise E. Gianneotis-

RECEIVED  
BLM AZ STATE OFFICE  
2016 AUG 12 A 10:10  
PHOENIX, ARIZONA

AHC 438994

N  
**MINING CLAIM MAP**

Lode ( ) Placer (X)  
Mill-site ( )

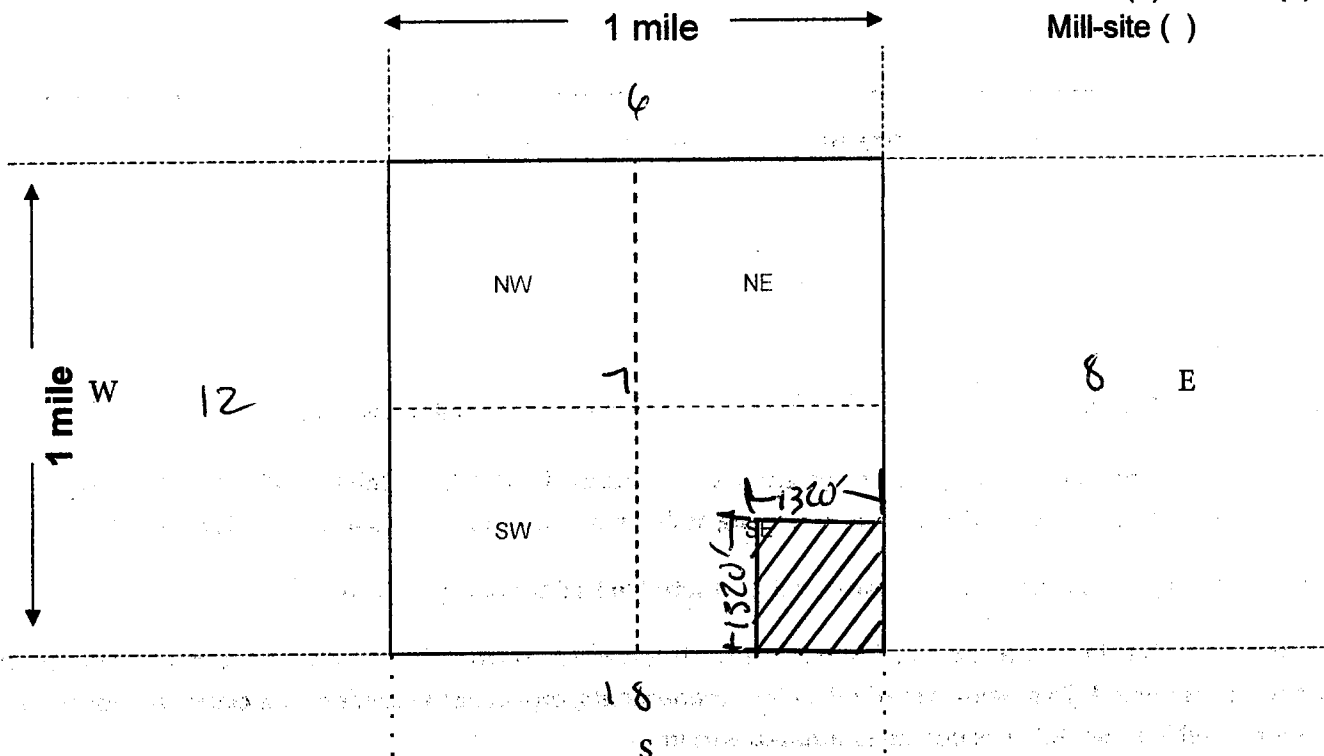

Scale: 1" = 2000 feet



1. The above map depicts the P7-10 mining claim, which is located in Section (s) 7, Township 3 N, Range 18W, Gila and Salt River Base and Meridian, La Paz County, Arizona. Total claim acreage is 40
2. The type of corner and location monuments used are as follows: 2 X 2 Wood Post
3. The bearings and distances in degrees and feet between claim corners and to a public land survey monument are as depicted on the map.
4. If the claim is a placer or mill-site claim with exterior limits conforming to legal subdivisions of the public survey, provide a legal description of the claim SE 1/4 SE 1/4

County Recorder Space:

Grand Canyon Gold Corp  
16772 W. Bell Rd #110-417  
Surprise, AZ 85374  
(310)-365-0783



2016-02717  
Page 1 of 2  
Requested By: Grand Canyon Gold Corp  
SHELLY D BAKER, RECORDER  
OFFICIAL RECORDS OF LA PAZ COUNTY, AZ  
07-20-2016 11:40 AM Recording Fee \$10.00

## LOCATION NOTICE PLACER MINING CLAIM

NOTICE IS HEREBY GIVEN that the **P7-11** placer mining claim has been

Located by Grand Canyon Gold Corp, whose current mailing address is; 16772 W. Bell RD #110-417, Surprise, AZ 85374, and Denise E. Giannetis whose current mailing address is: 16772 W. Bell Rd #110-417 Surprise, AZ 85374

The general course of the claim is east to west and is situated in La Paz County, Arizona.

This claim is 1320' feet in length and 1320' feet in width. This claim runs from the location monument on which this location notice is posted. This claim is marked by four monuments, one at each corner of the claim. The location monument on which this Notice is posted is situated within:

Township 3 North, Range 18 West, Section 7, Quarter Section: SW ¼ SE ¼

La Paz County, Arizona. Gila & Salt River Base and Meridian. This claim is 40 acres in size.

The locality of this claim with reference to some natural object or permanent monument and additional information (if any) concerning its locality is as follows: Section Marker and natural stone with wood post.

Dated and posted on the ground this 15<sup>TH</sup> day of May, 2016.

Grand Canyon Gold Corp:   
Panos D. Giannetis-CEO

Denise E. Giannetis.:   
Denise E. Giannetis-

PHOENIX, ARIZONA

2016 AUG 12 A 10:10

RECEIVED  
BLM AZ STATE OFFICE

AHC438995

N  
**MINING CLAIM MAP**

Lode ( ) Placer (X)  
Mill-site ( )

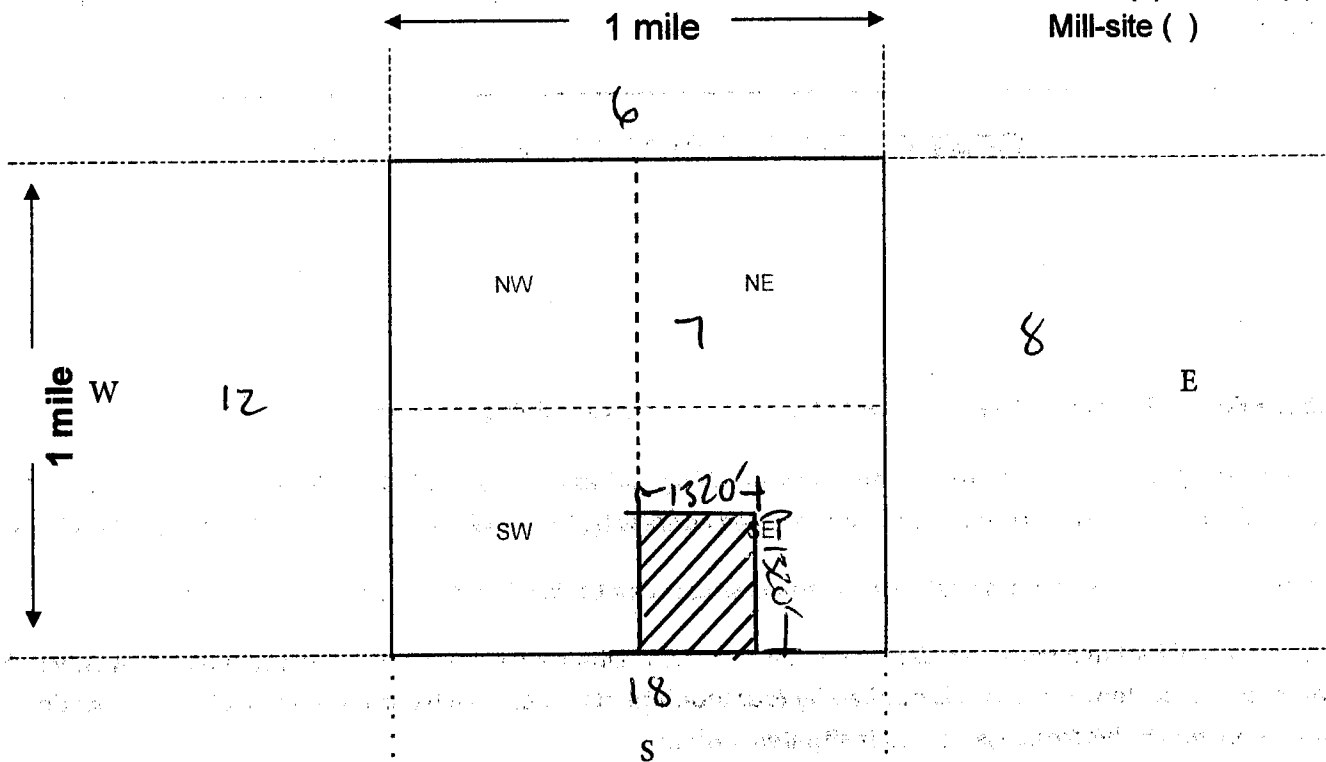

Scale: 1" = 2000 feet



1. The above map depicts the P7-11 mining claim, which is located in Section (s) 7, Township 3 N, Range 18W, Gila and Salt River Base and Meridian, La Paz County, Arizona. Total claim acreage is 40
2. The type of corner and location monuments used are as follows: 2 X 2 Wood Post
3. The bearings and distances in degrees and feet between claim corners and to a public land survey monument are as depicted on the map.
4. If the claim is a placer or mill-site claim with exterior limits conforming to legal subdivisions of the public survey, provide a legal description of the claim SW 1/4 SE 1/4

County Recorder Space:

Grand Canyon Gold Corp  
16772 W. Bell Rd #110-417  
Surprise, AZ 85374  
(310)-365-0783



2016-02718  
Page 1 of 2  
Requested By: Grand Canyon Gold Corp  
SHELLY D BAKER, RECORDER  
OFFICIAL RECORDS OF LA PAZ COUNTY, AZ  
07-20-2016 11:40 AM Recording Fee \$10.00

## LOCATION NOTICE PLACER MINING CLAIM

NOTICE IS HEREBY GIVEN that the **P7-12** placer mining claim has been

Located by Grand Canyon Gold Corp, whose current mailing address is; 16772 W. Bell RD #110-417, Surprise, AZ 85374, and Denise E. Gianneotis whose current mailing address is: 16772 W. Bell Rd #110-417 Surprise, AZ 85374

The general course of the claim is east to west and is situated in La Paz County, Arizona.

This claim is 1320' feet in length and 1320' feet in width. This claim runs from the location monument on which this location notice is posted. This claim is marked by four monuments, one at each corner of the claim. The location monument on which this Notice is posted is situated within:

Township 3 North, Range 18 West, Section 7, Quarter Section: NW ¼ SW ¼

La Paz County, Arizona. Gila & Salt River Base and Meridian. This claim is 40 acres in size.

*Amc 438996 P7-12  
WITH IN LOT #3*

The locality of this claim with reference to some natural object or permanent monument and additional information (if any) concerning its locality is as follows: Section Marker and natural stone with wood post.

Dated and posted on the ground this 15<sup>TH</sup> day of May, 2016.

Grand Canyon Gold Corp: *Panos D. Gianneotis*  
Panos D. Gianneotis-CEO

Denise E. Gianneotis.: *Denise E. Gianneotis*  
Denise E. Gianneotis-

PHOENIX, ARIZONA

2016 AUG 12 A 10:10

RECEIVED  
BLM AZ STATE OFFICE

AHC438996

N  
**MINING CLAIM MAP**

Lode ( ) Placer (X)  
Mill-site ( )

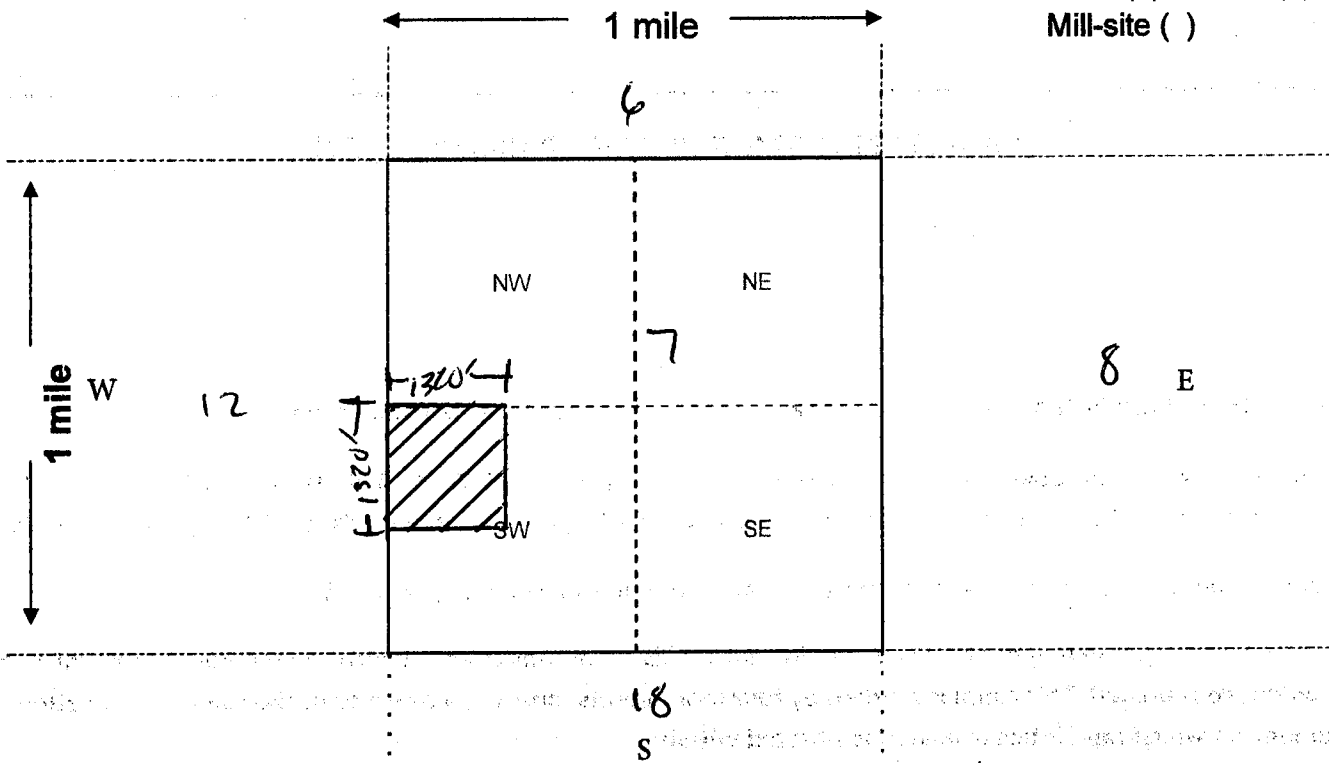

Scale: 1" = 2000 feet



1. The above map depicts the P7-12 mining claim, which is located in Section (s) 7, Township 3 N, Range 18W, Gila and Salt River Base and Meridian, La Paz County, Arizona. Total claim acreage is 40
2. The type of corner and location monuments used are as follows: 2 X 2 Wood Post
3. The bearings and distances in degrees and feet between claim corners and to a public land survey monument are as depicted on the map.
4. If the claim is a placer or mill-site claim with exterior limits conforming to legal subdivisions of the public survey, provide a legal description of the claim NW 1/4 SW 1/4

County Recorder Space:

Grand Canyon Gold Corp  
16772 W. Bell Rd #110-417  
Surprise, AZ 85374  
(310)-365-0783



2016-02719  
Page 1 of 2  
Requested By: Grand Canyon Gold Corp  
SHELLY D BAKER, RECORDER  
OFFICIAL RECORDS OF LA PAZ COUNTY, AZ  
07-20-2016 11:40 AM Recording Fee \$10.00

## LOCATION NOTICE PLACER MINING CLAIM

NOTICE IS HEREBY GIVEN that the **P7-13** placer mining claim has been

Located by Grand Canyon Gold Corp, whose current mailing address is; 16772 W. Bell RD #110-417, Surprise, AZ 85374, and Denise E. Gianneotis whose current mailing address is: 16772 W. Bell Rd #110-417 Surprise, AZ 85374

The general course of the claim is east to west and is situated in La Paz County, Arizona.

This claim is 1320' feet in length and 1320' feet in width. This claim runs from the location monument on which this location notice is posted. This claim is marked by four monuments, one at each corner of the claim. The location monument on which this Notice is posted is situated within:

Township 3 North, Range 18 West, Section 7, Quarter Section: NE ¼ SW ¼

La Paz County, Arizona. Gila & Salt River Base and Meridian. This claim is 40 acres in size.

The locality of this claim with reference to some natural object or permanent monument and additional information (if any) concerning its locality is as follows: Section Marker and natural stone with wood post.

Dated and posted on the ground this 15<sup>TH</sup> day of May, 2016.

Grand Canyon Gold Corp:   
Panos D. Gianneotis-CEO

Denise E. Gianneotis.:   
Denise E. Gianneotis-

RECEIVED  
BLM AZ STATE OFFICE  
2016 AUG 12 A 10:10  
PHOENIX, ARIZONA

AHC438997

Map on reverse side

N  
**MINING CLAIM MAP**

Lode ( ) Placer (X)  
Mill-site ( )

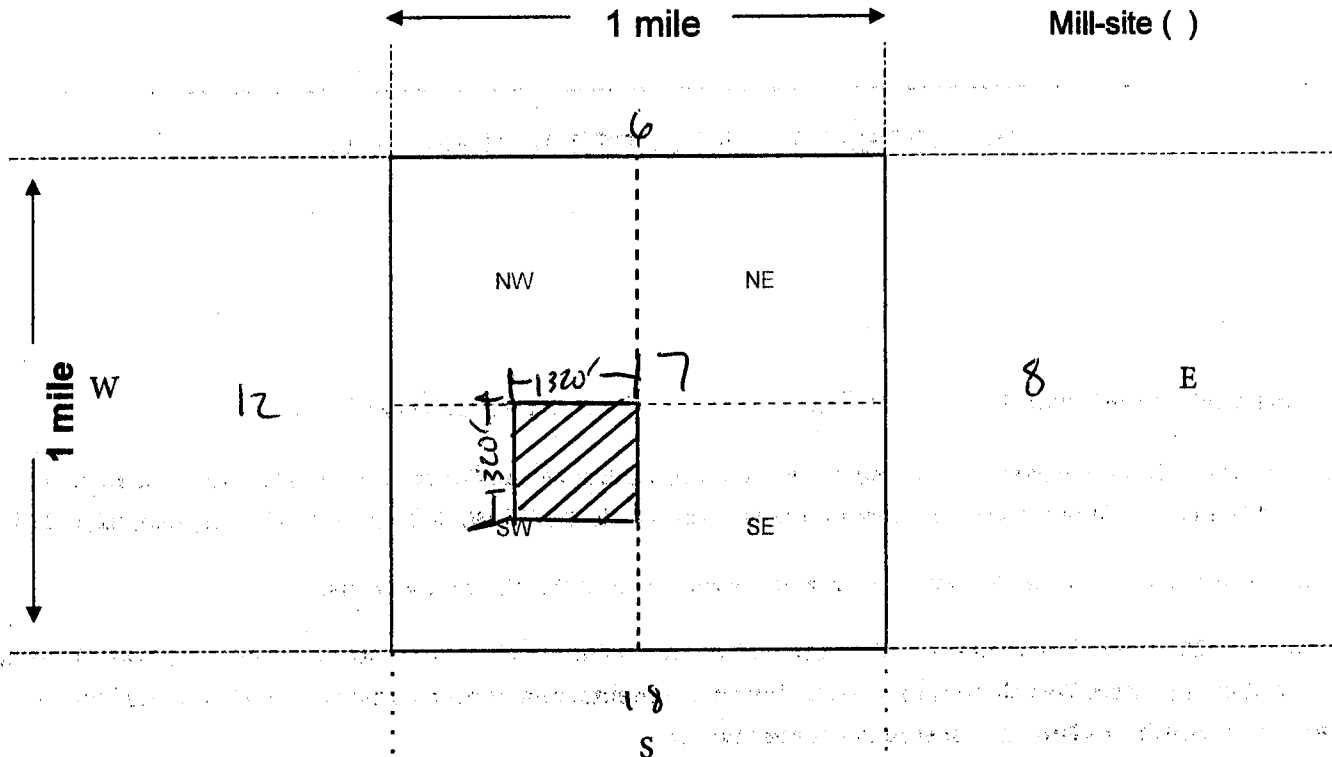

Scale: 1" = 2000 feet



1. The above map depicts the P7-13 mining claim, which is located in Section (s) 7, Township 3 N, Range 18W, Gila and Salt River Base and Meridian, La Paz County, Arizona. Total claim acreage is 40
2. The type of corner and location monuments used are as follows: 2 X 2 Wood Post
3. The bearings and distances in degrees and feet between claim corners and to a public land survey monument are as depicted on the map.
4. If the claim is a placer or mill-site claim with exterior limits conforming to legal subdivisions of the public survey, provide a legal description of the claim NE 1/4 SW 1/4





County Recorder Space:

Grand Canyon Gold Corp  
16772 W. Bell Rd #110-417  
Surprise, AZ 85374  
(310)-365-0783

2016-02720  
Page 1 of 2  
Requested By: Grand Canyon Gold Corp  
SHELLY D BAKER, RECORDER  
OFFICIAL RECORDS OF LA PAZ COUNTY, AZ  
07-20-2016 11:40 AM Recording Fee \$10.00

## LOCATION NOTICE PLACER MINING CLAIM

NOTICE IS HEREBY GIVEN that the **P7-14** placer mining claim has been

Located by Grand Canyon Gold Corp, whose current mailing address is; 16772 W. Bell RD #110-417, Surprise, AZ 85374, and Denise E. Gianneotis whose current mailing address is: 16772 W. Bell Rd #110-417 Surprise, AZ 85374

The general course of the claim is east to west and is situated in La Paz County, Arizona.

This claim is 1320' feet in length and 1320' feet in width. This claim runs from the location monument on which this location notice is posted. This claim is marked by four monuments, one at each corner of the claim. The location monument on which this Notice is posted is situated within:

Township 3 North, Range 18 West, Section 7, Quarter Section: SE ¼ SW ¼

La Paz County, Arizona. Gila & Salt River Base and Meridian. This claim is 40 acres in size.

The locality of this claim with reference to some natural object or permanent monument and additional information (if any) concerning its locality is as follows: Section Marker and natural stone with wood post.

Dated and posted on the ground this 15<sup>TH</sup> day of May, 2016.

Grand Canyon Gold Corp:

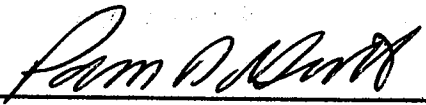
  
Panos D. Gianneotis-CEO

Denise E. Gianneotis:

  
Denise E. Gianneotis-

PHOENIX, ARIZONA

2016 AUG 12 A 10:10

RECEIVED  
BLM AZ STATE OFFICE

AHC438998

N  
**MINING CLAIM MAP**

Lode ( ) Placer (X)  
Mill-site ( )

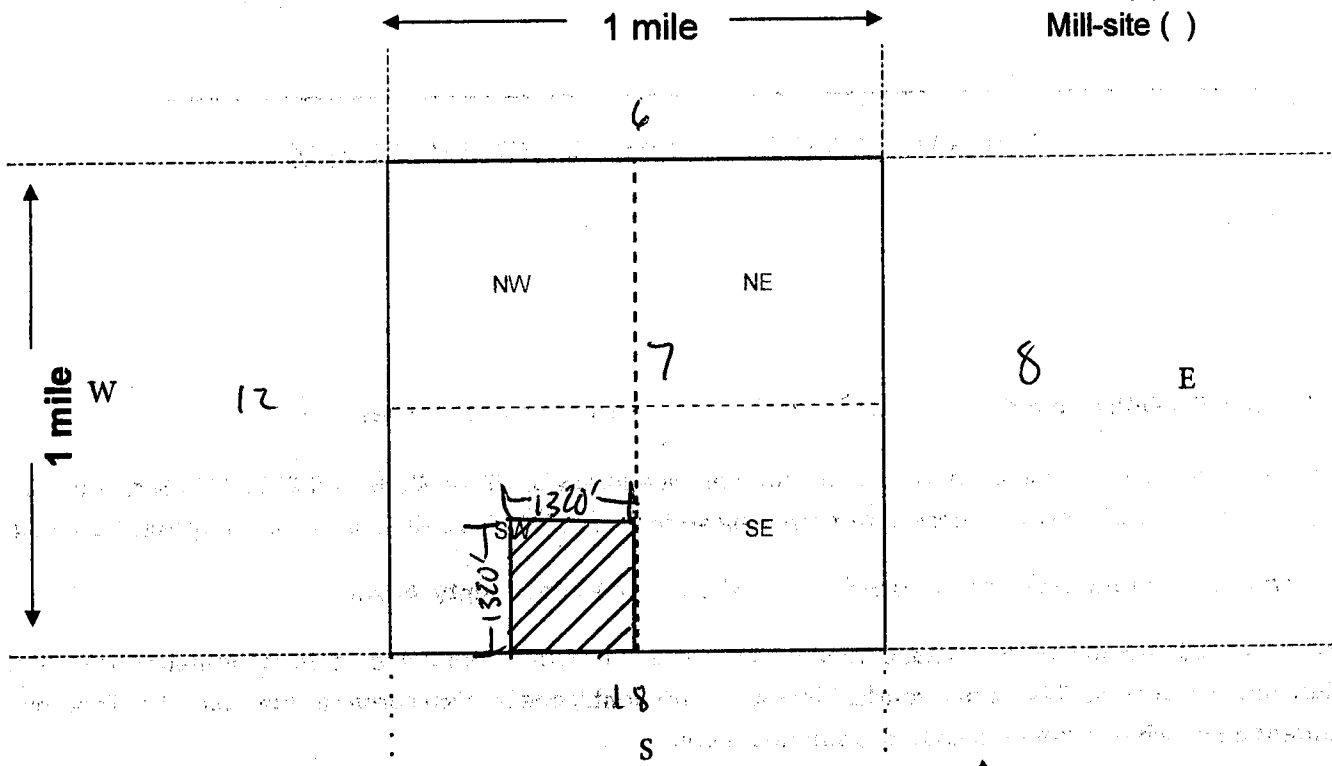

Scale: 1" = 2000 feet



1. The above map depicts the P7-14 mining claim, which is located in Section (s) 7, Township 3 N, Range 18W, Gila and Salt River Base and Meridian, La Paz County, Arizona. Total claim acreage is 40
2. The type of corner and location monuments used are as follows: 2 X 2 Wood Post
3. The bearings and distances in degrees and feet between claim corners and to a public land survey monument are as depicted on the map.
4. If the claim is a placer or mill-site claim with exterior limits conforming to legal subdivisions of the public survey, provide a legal description of the claim SE 1/4 SW 1/4

County Recorder Space:

Grand Canyon Gold Corp  
16772 W. Bell Rd #110-417  
Surprise, AZ 85374  
(310)-365-0783



2016-02721  
Page 1 of 2  
Requested By: Grand Canyon Gold Corp  
SHELLY D BAKER, RECORDER  
OFFICIAL RECORDS OF LA PAZ COUNTY, AZ  
07-20-2016 11:40 AM Recordings Fee \$10.00

## LOCATION NOTICE PLACER MINING CLAIM

NOTICE IS HEREBY GIVEN that the **P7-15** placer mining claim has been

Located by Grand Canyon Gold Corp, whose current mailing address is; 16772 W. Bell RD #110-417, Surprise, AZ 85374, and Denise E. Gianneotis whose current mailing address is: 16772 W. Bell Rd #110-417 Surprise, AZ 85374

The general course of the claim is east to west and is situated in La Paz County, Arizona.

This claim is 1320' feet in length and 1320' feet in width. This claim runs from the location monument on which this location notice is posted. This claim is marked by four monuments, one at each corner of the claim. The location monument on which this Notice is posted is situated within:

Township 3 North, Range 18 West, Section 7, Quarter Section: SW ¼ SW ¼

AMC 438999 P7-15  
WITHIN LOT-4

La Paz County, Arizona. Gila & Salt River Base and Meridian. This claim is 40 acres in size.

The locality of this claim with reference to some natural object or permanent monument and additional information (if any) concerning its locality is as follows: Section Marker and natural stone with wood post.

Dated and posted on the ground this 15<sup>TH</sup> day of May, 2016.

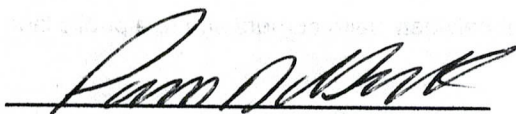
Grand Canyon Gold Corp:   
Panos D. Gianneotis-CEO

Denise E. Gianneotis:   
Denise E. Gianneotis-

PHOENIX, ARIZONA

2016 AUG 12 A 10:10

RECEIVED  
BLM AZ STATE OFFICE

AHC438999

N  
**MINING CLAIM MAP**

Lode ( ) Placer (X)  
Mill-site ( )

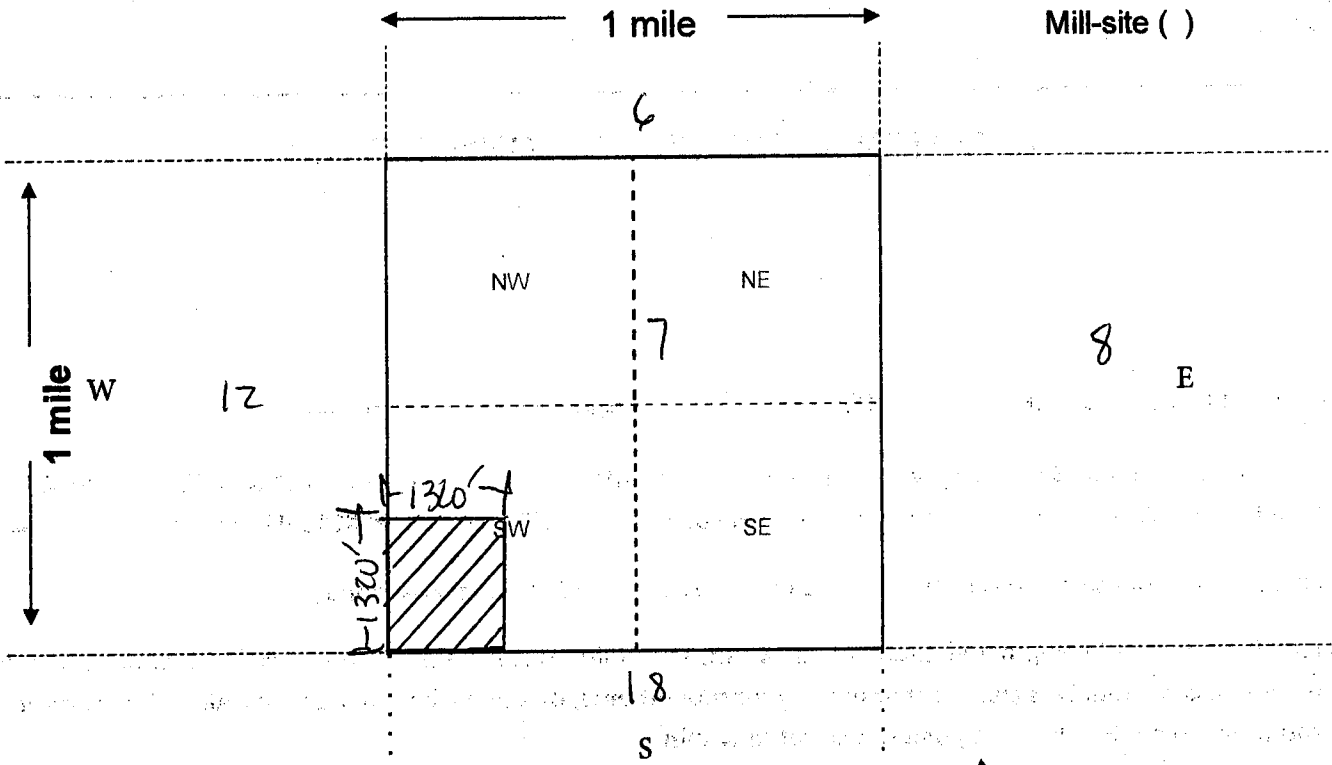

Scale: 1" = 2000 feet



1. The above map depicts the P7-15 mining claim, which is located in Section (s) 7, Township 3 N, Range 18W, Gila and Salt River Base and Meridian, La Paz County, Arizona. Total claim acreage is 40
2. The type of corner and location monuments used are as follows: 2 X 2 Wood Post
3. The bearings and distances in degrees and feet between claim corners and to a public land survey monument are as depicted on the map.
4. If the claim is a placer or mill-site claim with exterior limits conforming to legal subdivisions of the public survey, provide a legal description of the claim SW 1/4 SW 1/4



TOWNSHIP 03 NORTH RANGE 18 WEST OF THE GILA & SALT RIVER MERIDIAN, ARIZONA

SECS	SUBDIVISION																Acres	Kind of Entry or Purpose	Serial Number or Order Number	Action Date	Remarks		
	NE 1/4				NW 1/4				SW 1/4				SE 1/4									Lots	Other Description
	NE	NW	SW	SE	NE	NW	SW	SE	NE	NW	SW	SE	NE	NW	SW	SE							
	For orders affecting disposal or use of unidentified lands withdrawn for classification, minerals, water, and/or other public purposes, and Indian treaties, refer to Index to Miscellaneous Documents																						
																	MS 2131;	79.739	PATENT / ME	45790	9/20/1907	MC 291; 4N 18W;	
																	ALL SECS 2, 16, 32, 36;		STATE GRANT	ACT OF CONGRESS	6/20/1910	TITLE TO STATE TO FIX ON APPROVAL OF SURVEY; SUBJECT TO PRIOR RIGHTS;	
																	MS 2949;	33.10	PATENT / ME	451595	1/5/1915		
36								X	X	X	X	X	X	X	X		320.00	IL BASE	91	7/7/1926	7N 3E;		
																	ALL SECS 2, 16, 32, 36;		STATE GRANT	ACT OF CONGRESS	1/25/1927	EXTENDS ACT OF 6/20/1910 TO MINERAL LANDS; SUBJECT TO PRIOR RIGHTS;	
2																	PART 7, 8	89.12	IL BASE	97	4/11/1929	28N 2E;	
2																	PART 5	40.29	IL BASE	98	1/8/1930	15S 21E;	
2																	6, 9, 10, PART 7, 8	117.38	IL BASE	153	8/7/1936	20S 12E;	
2																	PART;	14.14	IL BASE	185	11/3/1938	28N 6W;	
16					X	X																	
32																	ALL;						
36	X	X	X	X	X	X	X	X	X										QCD TO US / SX	PHX-075416	4/5/1941	14N 13W;	
16					X			X											QCD TO US / SX	PHX-081212	4/18/1947	5N 14W;	
31																	M&B; SUBDIV UNDEF;		R/W PIPE LINE	PHX-083225	3/1/1949	PERPETUAL; 2N 11W;	
16	X	X	X	X				X	X	X	X	X	X	X	X		1N 19W;		QCD TO US / SX	PHX-080590	7/5/1949	O OPENING TO ENTRY 7/10/1951;	
16	X	X	X	X				X	X	X	X	X	X	X	X			480.00	O OPENING TO ENTRY	55176	7/10/1951	37N 5E;	
31																	M&B; SUBDIV UNDEF;		R/W PIPE LINE	AR-03819	10/17/1952	PERPETUAL; 2N 16W; PROOF OF CONSTRUCTION 1/19/1954;	
4																	6, 8	39.94	PATENT / ME	1162771	8/3/1956		
31																	M&B; SUBDIV UNDEF;		R/W PIPE LINE	AR-016499	7/16/1957	PERPETUAL; 2N 18W;	
2																	PART MS 2949;	18.96	IL BASE	266	1/20/1960	1S 19E;	
																	PART DEFICIT;	1.04	IL BASE	276	1/5/1961	13S 2E;	
4																	7	19.86	PATENT / ME	1220003	5/25/1961		
4																	S2S2NE, N2NESE, NENWSE;	70.00	PATENT / ME	02-64-0270	6/16/1964		
2																	PART 5	0.11	IL BASE	329	7/23/1965	6S 5W;	
3																	ALL;						
4																	ALL;						
5																	ALL;						

TOWNSHIP 03 NORTH RANGE 18 WEST OF THE GILA & SALT RIVER MERIDIAN, ARIZONA

SECs	SUBDIVISION																Acres	Kind of Entry or Purpose	Serial Number or Order Number	Action Date	Remarks		
	NE 1/4				NW 1/4				SW 1/4				SE 1/4									Lots	Other Description
	NE	NW	SW	SE	NE	NW	SW	SE	NE	NW	SW	SE	NE	NW	SW	SE							
For orders affecting disposal or use of unidentified lands withdrawn for classification, minerals, water, and/or other public purposes, and Indian treaties, refer to Index to Miscellaneous Documents																							
6																	ALL;						
7																	ALL;						
8																	ALL;						
9																	ALL;						
10																	ALL;						
17																	ALL;						
18																	ALL;						
19																	ALL;						
20																	ALL;						
29																	ALL;						
30																	ALL;						
31																	ALL;						
32																	ALL; 1N 13W;	O PROPOSED CL FOR MULTIPLE USE MANAGEMENT	A-1099	7/21/1967	SEGREGATES THE PUBLIC LANDS FROM APPROPRIATION UNDER AGRICULTURAL LAND LAWS, PS, SX; PUB IN FR 7/27/1967; O CL 10/17/1967; PUB IN FR 10/23/1967; CL TERM 10/7/1981;		
1																	ALL;						
2																	ALL;						
11																	ALL;						
12																	ALL;						
13																	ALL;						
14																	ALL;						
15																	ALL;						
16																	ALL;						
17																	ALL;						
18																	ALL;						
19																	ALL;						
20																	ALL;						
21																	ALL;						
22																	ALL;						
23																	ALL;						

TOWNSHIP 03 NORTH RANGE 18 WEST OF THE GILA & SALT RIVER MERIDIAN, ARIZONA

SECs	SUBDIVISION																Acres	Kind of Entry or Purpose	Serial Number or Order Number	Action Date	Remarks		
	NE 1/4				NW 1/4				SW 1/4				SE 1/4									Lots	Other Description
	NE	NW	SW	SE	NE	NW	SW	SE	NE	NW	SW	SE	NE	NW	SW	SE							
For orders affecting disposal or use of unidentified lands withdrawn for classification, minerals, water, and/or other public purposes, and Indian treaties, refer to Index to Miscellaneous Documents																							
24																		ALL;					
25																		ALL;					
26																		ALL;					
27																		ALL;					
28																		ALL;					
33																		ALL;					
34																		ALL;					
35																		ALL;					
36																		ALL; 1N 10W;	O PROPOSED CL FOR MULTIPLE USE MANAGEMENT	A-1101	7/21/1967	SEGREGATES THE PUBLIC LANDS FROM APPROPRIATION UNDER AGRICULTURAL LAND LAWS, PS, SX; PUB IN FR 7/27/1967; O CL 10/17/1967; PUB IN FR 10/23/1967; CL TERM 10/7/1981;	
ENTIRE TOWNSHIP																	1N 15W;	APLN / WDL KOFA NATIONAL WILDLIFE RANGE	A-7950	2/21/1974	WITHDRAWN FROM ALL FORMS OF APPROPRIATION INCLUDING THE MINING LAWS AND MINERAL LEASING LAWS; PUB IN FR 12/22/1977; APLN WDN AND CASE CLOSED 4/15/1991;		
3													4										
4														NESENE;					R/W ROAD	A-16203	1/4/1982	TO TERM 1/3/2012;	
4									X	X	X	X					3		R/W WATER WELL AND PIPE LINE	A-18910	11/7/1983	TO TERM 11/6/2003;	
1				X													X						X
12	X																						
23	X	X	X	X	X	X	X	X															
24	X	X	X	X	X	X	X	X						X	X	X	X		3N 17W;	R/W ROAD	AZA-35714-06	9/23/2011	TO TERM 12/31/2030;



DEPARTMENT OF INTERIOR  
BUREAU OF LAND MANAGEMENT

Input Parameters for Geographic Report with Land

System Id = CR

Admin State = AZ

Geo State =

Casetype Begins With

Case Disp Txt = AUTHORIZED, CANCELLED, EXPIRED, PENDING, REJECTED, RELINQUISHED, VOID, WITHDRAWN

Mer Twp Rng =

Section =

Mtrs = 14 0030N 0180W 007, 14 0030N 0180W 999

Commodity =

Commodity Txt =

Pending Org =

Pend Org Decode =

Total Rows Returned: 0